

Large-scale facilities in suburban areas

Sapporo Convention Center	57
Sapporo Business Innovation Center ...	58
Axes Sapporo (Sapporo Exposition Center)	59
Hokkai Kitayell (Hokkaido Prefectural Sports Center)	60
Sapporo Art Park [Art Hall]	61
Sapporo Dome (HIROBA)	62
Sapporo Hotel Yamachi	63
Hotel Emisia Sapporo	64
Shin-Sapporo ARC City Hotel	65
Sapporo Comprehensive Learning Center (Chieria)	66
Tsudome (Sapporo Community Dome)	67
Glass Pyramid In Moerenuma Park (HIDAMARI)	68
CHÂTERAISE Gateaux kingdom SAPPORO	69



Large-scale
facilities in
suburban
areas

Sapporo Convention Center

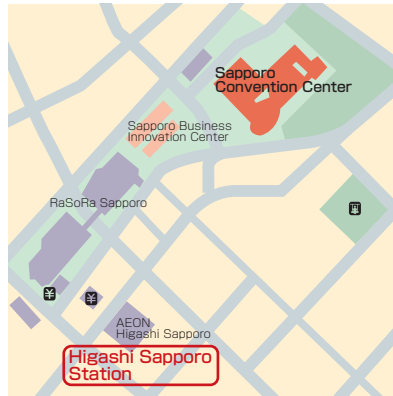

- Address...1-chome, Higashi-Sapporo 6-jo, Shiroishi-ku, Sapporo
- Tel...+81-11-817-1010
- Fax...+81-11-820-4300
- URL...<https://www.sora-scc.jp/>
- E-mail...info@sora-scc.jp
- Access
 - [Subway] 8 mins. on foot from Higashi-Sapporo Subway Station on the Tozai Line
 - [Bus] Hokkaido bus Shin-Sapporo line Sapporo Convention Center
 - [Taxi] 15 mins. from Sapporo Station (1500yen)
- Parking
 - 493 spaces
 - Ordinary motor vehicle: The first 2 hours are 200yen. Subsequently 100yen/30 mins.
 - Large-sized car: The first 2 hours are 500yen. Subsequently, 250yen/30 mins.

Convention Rooms

Name	Area (m ²)	Ceiling	Floor load	Dinner (people)	Buffet (people)	School (people)	Theater (people)	Basic rate (¥)
● Large Hall	[1F] 2,607	12m	5,000kg/m ²			1,200	2,500	304,900
● Special Conference Hall	[1F] 692	11m	300kg/m ²			252	700	237,900
● Medium-sized Hall	[1F] 564	6.5m	300kg/m ²			238	600	111,300
● Small Hall	[2F] 240	2.85~4.5m	300kg/m ²			193	193	45,000
● Conference Room 204	[2F] 283	3.15~4.3m	300kg/m ²			120	320	35,200

Basic rates are for eight hours' normal use, tax included. Rates are current as of March 2019. Please contact each facility directly for specific rates.

Hotel accommodation

Guestroom type	No. of rooms	No. of people	Notes
No accommodation facilities.			

Restaurants and Bars

Type	Number	Capacity	Notes
● Restaurant	1	100	
● Bar			
● Tea Lounge			
● Shop			

Main Floor Plan [1F·2F]

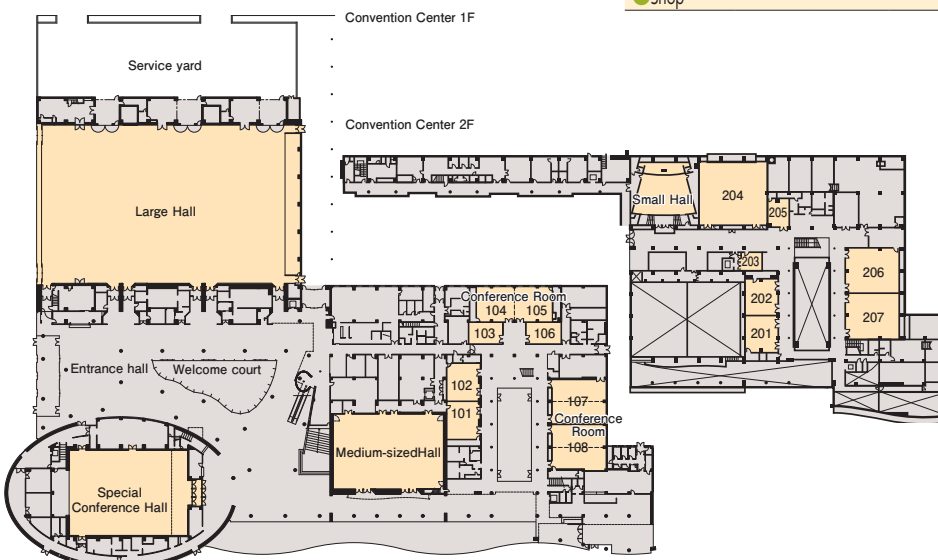

Special Features

This comprehensive convention center is designed to suit a variety of conferences, exhibitions and events ranging from a large-scale meeting of 2,500 people to small gatherings. State-of-the-art Internet facilities enable guests to have LAN access in each room.

Facilities/Notes

Main Facilities

[Large Hall] This is a multi-purpose hall which can be used for holding many events, from meetings to exhibitions. [Special Conference Hall] An international conference hall with translation service. There are 6 languages available. [Medium-sized Hall] This adjoins the pantry and is suitable for parties and receptions. [Small Hall] This is a staged theater type hall of reasonable size. [Conference Room 204] An arch-type ceiling envelops the atmosphere of any meeting. In addition, there are 14 conference rooms of various sizes.

Main Equipment for Loan or Rent

Hall equipment (temporary stage, chairs, desks) Image equipment (projector, OHP, slide projector, portable screen, plasma display console, document camera, system conversion video, slide video converter) Sound equipment (portable speaker set) Information equipment (LAN equipment set, LAN card, PHS) Equipment for ceremonies (national flag, certificate of merit tray, flower vase, gold-leafed folding screen, a set for a lecture, a ribbon cutting set for celebrations) Others (platform, chairman stand, flower box, exhibition panel, arm lamp, picture rail, microphone, nameplate stand, hand light, portable speaker, nameplate, digital camera, digital camcorder, camera tripod, portable CD, white board, laser pointer, direction stick, movable partition, partition pole, sign stand, poster stand, portable cashbox, monitor receiving box, electric lift, etc.)

Service

Internet Usage



Language Services



Management Support



Universal Accessibility



Credit Cards Accepted



Large-scale
facilities in
suburban
areas

Sapporo Business Innovation Center

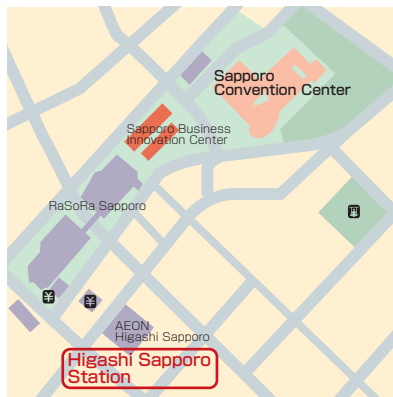

● Address...1-1, 1-chome, Higashi-Sapporo
5-jo, Shiroishi-ku, Sapporo

● Tel...+81-11-820-3033

● Fax...+81-11-820-3220

● URL...<http://www.sapporosansin.jp/>

● E-mail...info@sec.or.jp

● Access

[Subway] 7 mins. on foot from Higashi-Sapporo
Subway Station on the Tozai Line

[Taxi] 15 mins. from JR Sapporo Station (2,000yen)

● Parking

Available for customers of the Sapporo Business
Innovation Center only. 50 spaces (the number
may change)

The first 2 hours are 200yen. Subsequently,
100yen/ 30 mins.

Convention Rooms

Name	Area (m ²)	Ceiling	Floor load	Dinner (people)	Buffet (people)	School (people)	Theater (people)	Basic rate (¥)
● Seminar Room A [2F]	243					150		(15,800)
● Seminar Room B,C [2F]	99					42		(7,000)
● Seminar Room D [2F]	96					20		(7,700)
● Seminar Room 1 [3F]	147					90		(10,300)
● Seminar Room 2,3 [3F]	73					40		(5,200)
● Seminar Room 4~8 [3F]	51					20		(3,500)
● Seminar Room 9 [1F]	116					42		(7,700)
● Conference Room [1F]	30					14		(2,800)
● Gymnasium (April~October)	864							(15,000)
● (November~March)								(22,210)

Basic rates are for 8 hours' normal use, tax included. For rates in parentheses, please see more information at right.
Please contact each facility directly for specific rates.

Hotel accommodation

Guestroom type	No. of rooms	No. of people	Notes
No accommodation facilities.			

Restaurants and Bars

A restaurant area can be found in B-town of the
adjacent RASORA mall

Type	Number	Capacity	Notes
No attached eating or drinking establishments.			

Main Floor Plan

3F Skill training bldg.

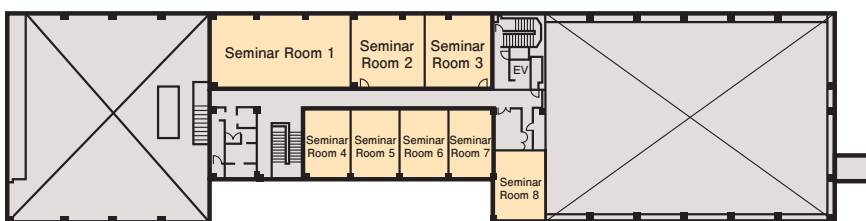

2F Industrial development bldg.

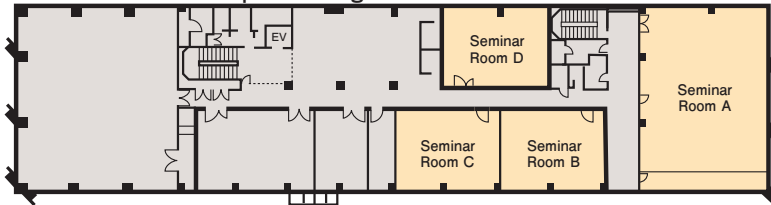

Seminar Room A

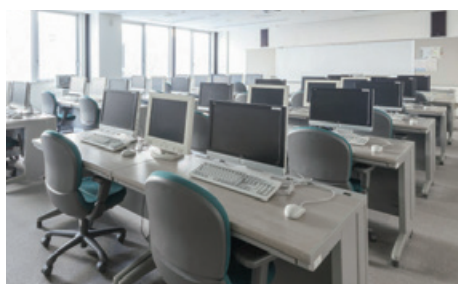

Seminar Room D

Special Features

The Sapporo Business Innovation Center supports small and medium-sized companies in the city by developing human resources, assisting start-up businesses, providing information and leasing seminar rooms. Seminar rooms are available for gatherings of 14 to 150 people. Projectors, micro phones, DVD players etc. are also available.

Facilities/Notes

Room Notes

In cases where small and medium-sized companies or groups of such companies wish to use the facilities for the purpose of training their employees, "training rates" can be applied for by submitting documents about the program. The "training rates" are half the amount of the basic rates. For commercial use, an extra 10% will be added to the basic rates. For events in which admission fees and/or anything of like value is collected, and the amount is over 4,001 yen, an extra 20% will be added to the basic rates. For use of the gymnasium, there will be heating charges from November through March.

Main Facilities

[Seminar Room A] Sound equipment screen, shading blind, 50 desks, 150 chairs [Seminar Room B-C] Screen, shading blind, 21 desks, 42 chairs [Seminar Room D] 21 computers, Sound equipment, projector, screen, shading blind [Seminar Room 1] Screen, 30 desks, 90 chairs [Seminar Room 2-3] Screen, 20 desks, 40 chairs [Seminar Room 4~8] Screen, 10 desks, 20 chairs [Seminar Room 9] Screen, 21 desks, 42 chairs [Conference Room] 3 arrangement tables, 14 chairs

Main Equipment for Loan or Rent

[Gymnasium] Sound equipment set [Available in each room] Projector, TV-videocassette recorder, Video-DVD player, wireless microphone, microphone stand, stereo set [Available in each room, except Gymnasium] Portable image and sound equipment set

Service

Internet Usage



The information outlet is installed in the seminar room.

Use of a dedicated Internet line with a speed of 2Mbps is possible via LAN in the facility. (Note) Communication, inc. email, with offsite parties is not available.

Wi-Fi is available at the Information Square on the first floor of the Industrial Development Building, in lounges of that building, and on the second floor of the Skill Training Building.

Universal Accessibility



Large-scale
facilities in
suburban
areas

Axes Sapporo

(Sapporo Exposition Center)

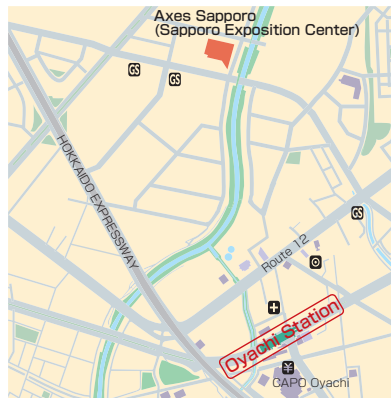

- Address...3-55, 4-chome Ryutsu Center, Shiroishi-ku, Sapporo
- Tel...+81-11-865-5811
- Fax...+81-11-864-1290
- URL...<http://www.axes.or.jp>
- Access
- [Subway] 15 mins. walk from Oyachi Subway Station on the Tozai Line.
- [JR] 5 mins. by taxi from Shin-Sapporo JR Station
- [Taxi] Approximately 35 mins. from Sapporo JR Station
- Parking
- 1,100 spaces, free of charge

Convention Rooms

Name	Area (m ²)	Ceiling	Floor load	Dinner (people)	Buffet (people)	School (people)	Theater (people)	Basic rate (¥)
● Large Exhibition Hall	5,000	(10m)	5t/m ²			4,000	5,500	(710,000)
● Outdoor Exhibition Space	2,400		5t/m ²					(80,000)
● Small Exhibition Hall	279	2.5m				150		(36,000)
● Reception Hall	121	6m				90		(22,000)
● Training Room A	150	2.5m				99		(16,000)
● Training Room B	100	2.5m				42		(15,000)

The under-beam ceiling height is 8.9 m (Large Exhibition Hall). Basic rates are for the use of 9am to 5pm. Tax is not included.

Hotel accommodation

Guestroom type	No. of rooms	No. of people	Notes
No accommodation facilities.			

Restaurants and Bars

Type	Number	Capacity	Notes
● Restaurant	1	140	
● Bar			
● Tea Lounge	1	80	
● Shop	1		

Main Floor Plan [1F]

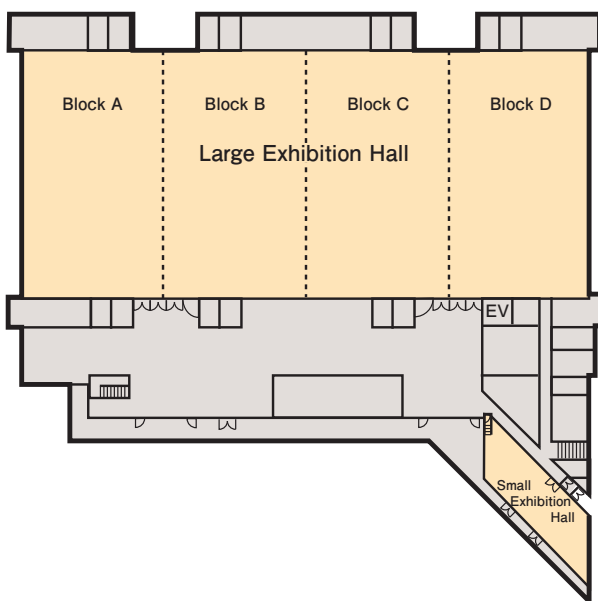

Special Features

The exhibition hall, measuring 100 meters in width and 50 meters in depth with an area of 5,000 square meters, is the largest hall in Hokkaido. The hall is built without columns and can be divided into four sections. The facility can be used as a multipurpose media space for trade fairs, various exhibitions and parties.

Facilities/Notes

Room Notes

Basic rates for Large Exhibition Hall and Outdoor Exhibition Hass are for the weekday use. Please contact the facility directly for details.

Service

Universal Accessibility



Large-scale
facilities in
suburban
areas

Hokkai Kitayell

(Hokkaido Prefectural Sports Center)

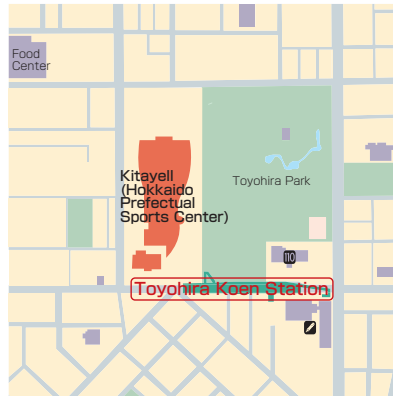

- Address...1-1, 11-chome, Toyohira 5-jo, Toyohira-ku, Sapporo
- Tel...+81-11-820-1703
- Fax...+81-11-833-0705
- URL...<http://www.kitayell.jp>
- Access
 - [Subway] Directly attached to Toyohira Koen Station on the Toho Line
 - [Taxi] 30 mins. ride from JR Sapporo Station
- Parking Only registered vehicles can be parked.
- Closed Two Mondays per month (not fixed) and from December 31 to January 2nd.
- Opening hours 9:00am~9:00pm (some facilities are open until 11:00pm)
- ※ Training room 8:30am~10:30pm

Convention Rooms

Name	Area (m ²)	Ceiling	Floor load	Dinner (people)	Buffet (people)	School (people)	Theater (people)	Basic rate (¥)
● Main Area	[B1] 3,886	Max. 26m	5t/m ²				10,000	
● Lecture Hall/Audiovisual Room	[2F] 240					150		
● Large Training Room	[2F] 183					100		
● Medium-sized Training Room	[2F] 96					60		
● Small Training Rooms (3 rooms)	[2F] 40					20 people each		

※Please contact for pricing details.

Hotel accommodation

Guestroom type	No. of rooms	No. of people	Notes
No accommodation facilities			

Restaurants and Bars

Type	Number	Capacity	Notes
● Restaurant	1		
● Bar			
● Tea Lounge			
● Shop	1		Open for events.

Main Floor Plan [1F]

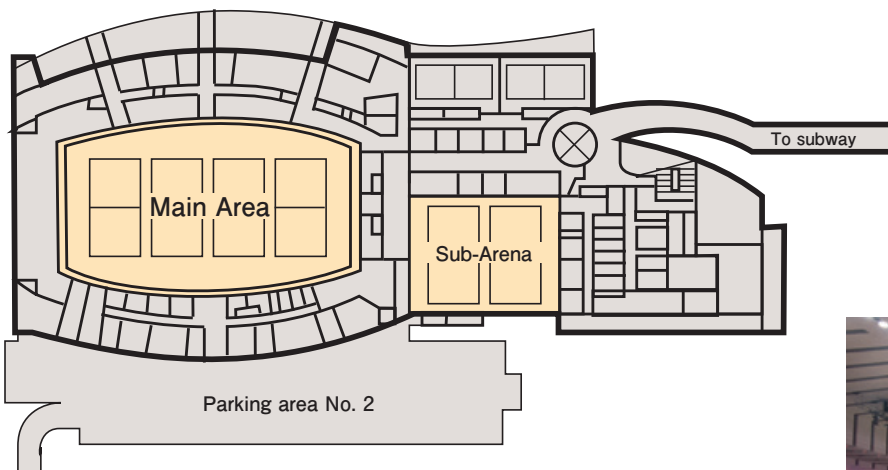

Special Features

This is a comprehensive facility that can accommodate various sports events including international and domestic competitions as well as cultural and educational events.

Facilities/Notes

Room Notes

[Main Arena 1·2 Floor] 4,000 fixed seats, 1,872 movable seats, maximum 10,000 capacity
Hall, Audio-visual Room and Large Training Room are available for use together.

Time periods

Morning 9:00am~1:00pm

Afternoon 1:00pm~5:00pm

Night 5:00pm~9:00pm

Late-night 9:00pm~11:00pm (only martial arts hall and sub-Arena)

Equipment for Loan or Rent

Projectors and screens are only available in the Hall and Audio-visual Room., Large Training Room, Medium-sized Training Room.

※Please contact for details of other rental equipment and charges.

Service

Universal Accessibility



Restroom for physically disabled people and ostomates. Studded paving blocks, group hearing aid system, voice guidance system.



Large-scale
facilities in
suburban
areas

Sapporo Art Park [Art Hall]



●Address...75, Geijutsu-no-Mori
2-chome, Minami-ku, Sapporo

●Tel...+81-11-592-5111

●Fax...+81-11-592-4120

●URL...<https://artpark.or.jp>

●Access

[Subway]Departs from Chuo Bus Platform 2 at Makomanai Subway Station on the Nanboku Line. Use the Soranuma bus line or Takino bus line. Approximately 15 mins. ride. Buses run every 15 mins. from Makomanai Station.

●Parking

Parking: 600 spaces

Regular cars 500yen; large cars 1,200 yen.

Parking coupon available with six uses for 1,000 yen

Convention Rooms

Name	Area (m ²)	Ceiling	Floor load	Dinner (people)	Buffet (people)	School (people)	Theater (people)	Basic rate (¥)
●Arena	[1,2F] 645						600	(18,500)
●Large Practice Room	[1F] 488						300	(11,100)
●Medium-sized Practice Room[2F]	171						150	(3,700)
●Small Practice Room 1,2	[2F] 47						10	(1,100)
●Small Practice Room 3,4,5	[2F] 30						10	(1,100)
●Small Practice Room 6	[2F] 40						10	(1,100)
●Piano Practice Room	[2F] 20						10	(1,300)

For rates in parentheses, please see more information at right. Tax included. Please contact each facility directly for specific rates.

Hotel accommodation

Guestroom type	No. of rooms	No. of people	Notes
No accommodation facilities.			

Restaurants and Bars

Type	Number	Capacity	Notes
●Restaurant	1	90	In the Art Park Center
●Bar			
●Tea Lounge	1	15	In the Art Park Museum

Main Floor Plan

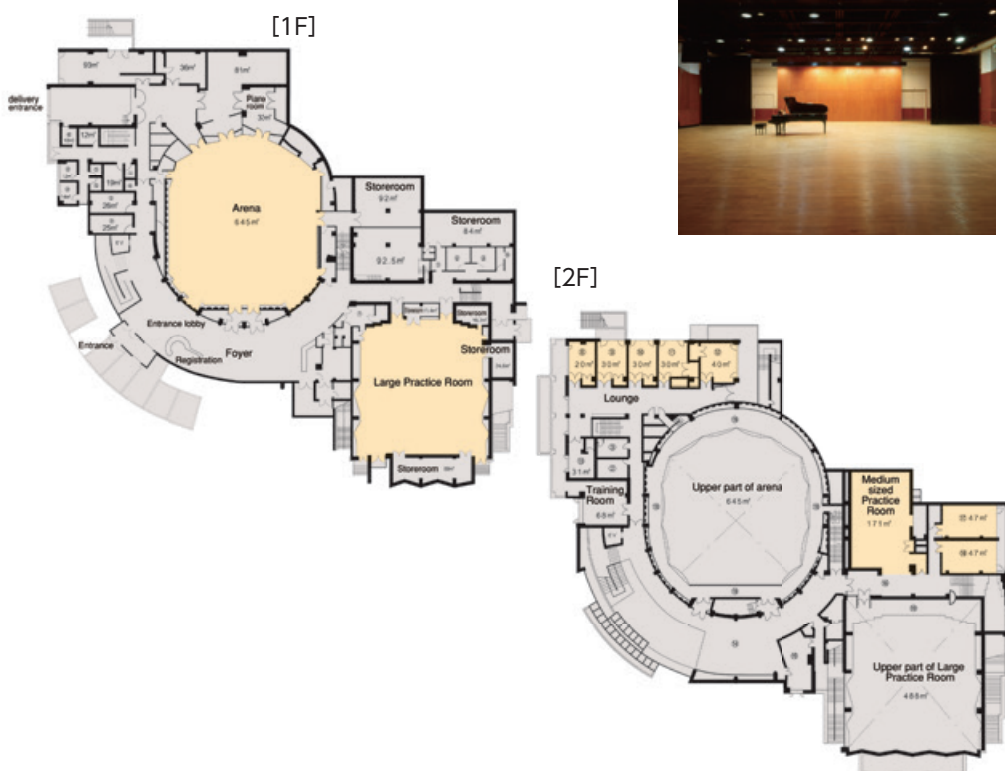

Special Features

The Art Hall has an arena that serves as a venue for symposiums and presentation sessions and as a place where an orchestra can rehearse, as well as having small, medium-sized and large practice rooms. The hall can be rented with a choice of four different time periods: 10:00~16:00 (daytime), 17:00~23:00 (night), 10:00~23:00 (day and night), 10:00~9:00 a.m. the next day (all day) (overnight stay possible). There is free equipment such as microphones, chairs for spectators, and a folding stage.

Facilities/Notes

Room Notes

Rates apply to charges for daytime use from 10:00~16:00.

Main Facilities

[Arena] Folding stage, anvil block, speaker, 500 Stacking chair

[Large Practice Room] Anvil block, speaker, 200 Stacking chair

[Medium-sized Practice Room] Speaker, 50 Stacking chair

[Small Practice Room] Speaker, 15 Stacking chair

[Piano Practice Room] 20 movable chairs
Pianos and drums can also be rented (for a fee).

Other Facilities

●These 40 hectares of verdant hills are dotted with various art facilities: the Sculpture Garden, the Art Museum, the Craft Studio, the Craft Hall (the Exhibit Hall, the Dyeing Studio, the Weaving Studio), the Woodworking Studio, the Ceramic Art Studio, the Print Studio, Ateliers, Lodges, the Takeo Arishima Residence, the Outdoor Stage and the Art Park Center. Art museum, Craft studio, Studio hall (exhibit hall, dyeing studio, weaving studio), woodworking studio, Ceramic art studio, Print studio, Atelier, Lodge, Takeo Arishima old mansion, Open-air stage, Art Hall center.

Hands-on crafts such as ceramic art, dyeing, glass and enameling on metal are taught in every studio.

Service

Universal Accessibility



Large-scale
facilities in
suburban
areas

Sapporo Dome (HIROBA)



- Address...1, Hitsujigaoka, Toyohira-ku, Sapporo
- Tel...+81-11-850-1000(Main)
- Fax...+81-11-850-1011
- URL...<https://www.sapporo-dome.co.jp/>
- Access
- [Subway] 10 mins. from Fukuzumi Subway Station on the Toho Line.
- [Taxi] 30 mins. ride from Sapporo Station.
- Parking
- 1,451 spaces.
- [For events] Normal car parking ticket (advance ticket needed) 2,500 yen
- [Other days] 300yen/first two hours (subsequently 100yen/30min)

Convention Rooms

Name	Area (m ²)	Ceiling	Floor load	Fixed seat	Arena capacity	Basic rate (¥)
● Closed Arena	14,460	63m	10t/m ²	(41,566)	(11,755)	(4,400,000)

Tax included. Rates may change. For figures in parentheses, please see more information at right.

Hotel accommodation

Guestroom type	No. of rooms	No. of people	Notes
No accommodation facilities			

Restaurants and Bars

Type	Number	Capacity	Notes
● Restaurant	1		
● Shop	37		Open only during events.

Main Floor Plan

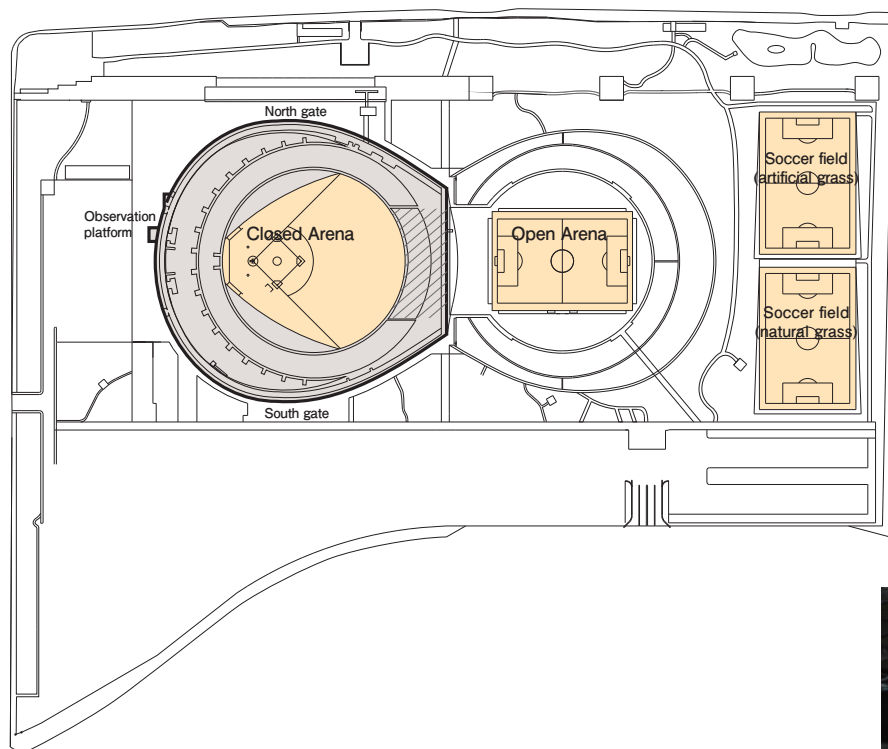

Special Features

This is the largest all-weather multi-purpose dome in Hokkaido, with an arena of 17,800 square meters and stands holding 41,566 seats. The dome accommodates various events including exhibitions, conventions and academic conferences.

Facilities/Notes

Room Notes

The size of the arena can be varied from 14,460 to 17,800 square meters by moving the stands. The usage of the stands is charged separately. 11-ton trucks can drive into the closed arena. Capacity changes according to the formation of the arena and stands.

[Closed arena] The basic rate is for one day (7 a.m. to midnight)

Other Facilities

- Two soccer practice fields ● observation platform ● training room ● kids' park

Service

Internet Usage



Management Support



Universal Accessibility



Credit Cards Accepted (Information Desk)



(Goods Shop)

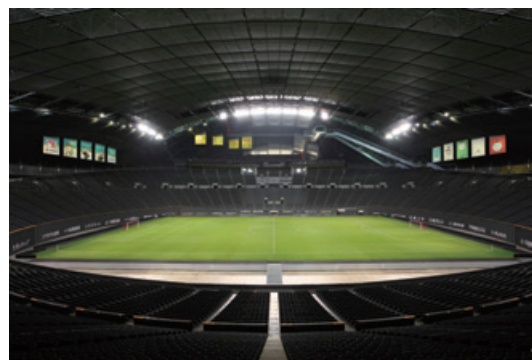

Large-scale
facilities in
suburban
areas

Sapporo Hotel Yamachi

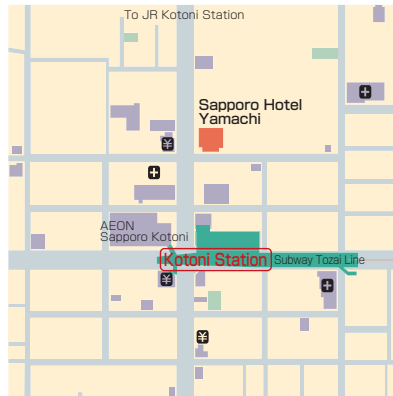

- Address...3-6, Kotoni 1-jo, 3-chome, Nishi-ku, Sapporo
- Tel...+81-11-644-5555
- Fax...+81-11-644-5744
- URL...<http://www.s-hotelyamachi.co.jp>
- E-mail...rsv@s-hotelyamachi.co.jp
- Access
- [Subway] 1 min. walk from exit 3 of Kotoni Subway Station on the Tozai Line.
- [JR] 6 mins. walk from JR Kotoni Station.
- [Taxi] 15 mins. ride from JR Sapporo Station.
- Parking
- 50 spaces, with fee.
- Special rate for banquet guests: 100yen/ 3 hours

Convention Rooms

Name	Area (m²)	Ceiling	Floor load	Dinner (people)	Buffet (people)	School (people)	Theater (people)	Basic rate (¥)
● Momoyama [2F]	139			96	136	100	160	
● Heian [3F]	368	5m		288	360	300	480	
● Katsura [3F]	31			18		18	25	
● Tachibana [2F]	31			18				
● Kaede [4F]	31			18				

Basic rates are for all day normal use, tax included. Rates may change.

Hotel accommodation

Guestroom type	No. of rooms	No. of people	Notes
● Japanese-style	2		
● Suite			
● Single	42		Including 16 deluxe singles.
● Twin	8		
● Other	1		
● Total	52		



Restaurants and Bars

Type	Number	Capacity	Notes
● Restaurant	2		Coffee & Restaurant "Elle", "Aoyama"
● Bar	1		Sky lounge "Rich"
● Tea Lounge			
● Shop			

Main Floor Plan [3F]

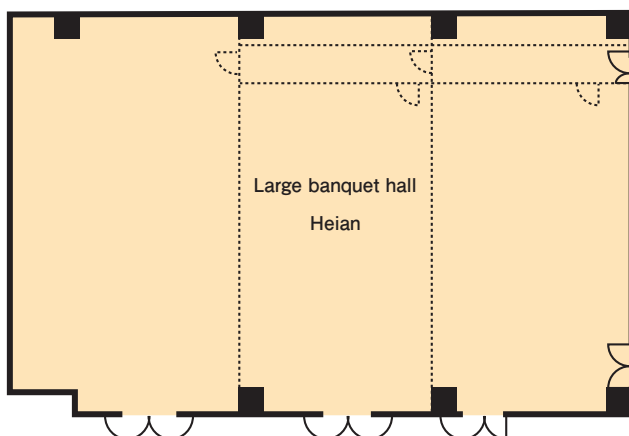

Special Features

The only international tourist hotel in Sapporo's Nishi-ku, this hotel is located in Kotoni, the city's second entertainment district after Susukino. Ten minutes' subway ride to Odori, in Sapporo city center. Conveniently located between Otaru and Sapporo, this hotel is ideal for both sightseeing and business.

Facilities/Notes

■ Main Equipment for Loan or Rent
Various sound equipment, 10-120 inch LCD projectors, presentation equipment, etc., iron, trouser press.

Service

- Internet Usage
- Management Support
- Universal Accessibility
- Credit Cards Accepted



Large-scale
facilities in
suburban
areas

Hotel Emisia Sapporo



- Address...5-chome, Atsubetsu-chuo 2-jo, Atsubetsu-ku, Sapporo
- Tel...+81-11-895-8811
- Fax...+81-11-895-8820
- URL...<http://www.hotel-emisia.com/>
- E-mail...emisia.sapporo@hotel-emisia.com
- Access
 - [Subway] 19 mins. subway ride from Odori Station. to Shin-Sapporo Station, and 1min. on foot from Shin-Sapporo Station.
 - [JR] 9 mins. train ride from JR Sapporo Station and 28 mins. from New Chitose airport, also 2 mins. on foot from JR Shin-Sapporo Station
- Parking
 - 200 spaces. 400yen/hour (Discount for hotel customers.)

Convention Rooms

Name	Area (m ²)	Ceiling	Floor load	Dinner (people)	Buffet (people)	School (people)	Theater (people)	Basic rate (¥)
● Palace Ballroom	[3F] 764	5.9m		500	700	480	900	
● Pastel	[2F] 404.2	3.1m		240	270	216	450	
● Palette	[2F] 393.6	3.1m		240	270	216	450	
● Crown	[3F] 142.6	2.7m		60	100	63	182	
● Casa Bianca	[31F] 92.9	7.0m		50	60	63	120	
● Symphony	[4F] 187	3.0m		100	100	100	60	
● Cattleya	[3F] 71.6	2.7m		40	40	30	80	
● Azalea	[3F] 64.1	2.7m		40	40	36	72	

*The rates listed apply to charges from 9am to 7pm. Please contact each facility directly for specific rates.

Hotel accommodation

Guestroom type	No. of rooms	No. of people	Notes
● Japanese-style	12	60	Including Japanese-Western rooms
● Suite	3	11	
● Single	71	71	
● Twin	384	1,088	Incl. accessible rooms
● Other	43	92	Incl. double and family rooms
● Total	513	1,322	Wireless Internet access and a 27-inch TV set are available in all rooms.

Restaurants and Bars

Type	Number	Capacity
● Restaurant	3	
● Tea Lounge	1	88



Main Floor Plan

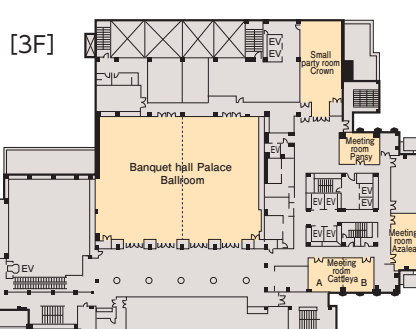
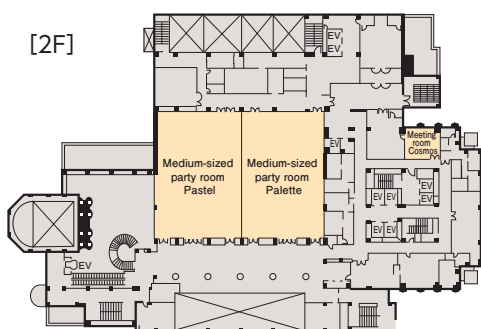

Special Features

Located in Sapporo's sub-center, Shin-Sapporo, this hotel has good access to both sightseeing spots and business districts. From the 32nd floor, guests can enjoy two different types of views – a natural view overlooking Noppo primeval forest and a city view of downtown Sapporo. An atrium space at a height of 25 meters on the first floor houses an authentic European-style chapel. Spa Alpa on the first basement level offers a relaxation area that can accommodate up to 350 guests — visitors can relieve the weariness of their journey with a variety of facilities including mist saunas and special saunas with antioxidating effects.

Facilities/Notes

Room Notes

Original theme parties available. Stylish hall coordination. There are also 13 other rooms including smaller conference rooms and Japanese-style rooms.

Main Equipment for Loan or Rent

Projector, screen, karaoke, sound equipment, TV, video recorder, DVD player, white board, etc.

Other Facilities

● Relaxation salon [Spa Alpa] ● beauty salon [Uyama] ● chapel ● shrine ● bakery shop [North Crest] ● wedding salon [Bellissimo] ● photo shop

Service

Internet Usage

Wi-Fi (all halls and rooms)

Language Services

(English, Chinese, Korean)

Management Support

Hotel Emisia Sapporo original plans are available.

Universal Accessibility



Credit Cards Accepted

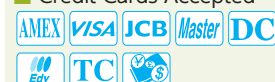

Large-scale
facilities in
suburban
areas

Shin-Sapporo ARC City Hotel



●Address...6-2, 5-chome, Atsubetsu Chuo 2-jo, Atsubetsu-ku, Sapporo

●Tel...+81-11-890-2525

●Fax...+81-11-890-2520

●URL...<http://www.arccityhotel.com>

●E-mail...hotel@arccityhotel.com

●Access

[Subway] Directly connected to exit 8 of Shin-Sapporo Station on the Tozai Line.

[JR] Shin-Sapporo Station on JR Chitose Line

[Bus] Shin-Sapporo Bus Terminal (JR Bus, Chuo Bus, Yutetsu Bus are available)

●Parking

800 spaces to be shared with visitors to the shopping mall, free of charge for guests staying at the hotel

Convention Rooms

Name	Area (m ²)	Ceiling	Floor load	Dinner (people)	Buffet (people)	School (people)	Theater (people)	Basic rate (¥)
●ARC Hall	[5F] 325			180	200	120	250	320,000
●Pearl (A)	[5F] 101			50	60	40	60	144,000
●ARC Hall (B)	[5F] 101			50	60	40	60	144,000
●Crystal (C)	[5F] 101			50	60	40	60	144,000
●Acacia	[4F] 99			50	50	30	60	120,000
●Hamanasu	[4F] 86			40	40	30	50	104,000
●Suzuran	[4F] 65			30	30	20	40	56,000
●Aoba (Japanese-style room) [5F]	68			48				96,000

Basic rates are for 8 hours of normal use. Service charges and tax are not included. Please contact each facility directly for specific rates.

Hotel accommodation

Guestroom type	No. of rooms
●Family room (Japanese-style room)	2
●Suite	1
●Single	95
●Twin	35
●Twin, Deluxe	2
●Total	135

Restaurants and Bars

Type	Number	Capacity	Notes
●Restaurant	1	100	Tea Lounge is within the restaurant.
●Tea Lounge			
●Shop			

Main Floor Plan [5F]

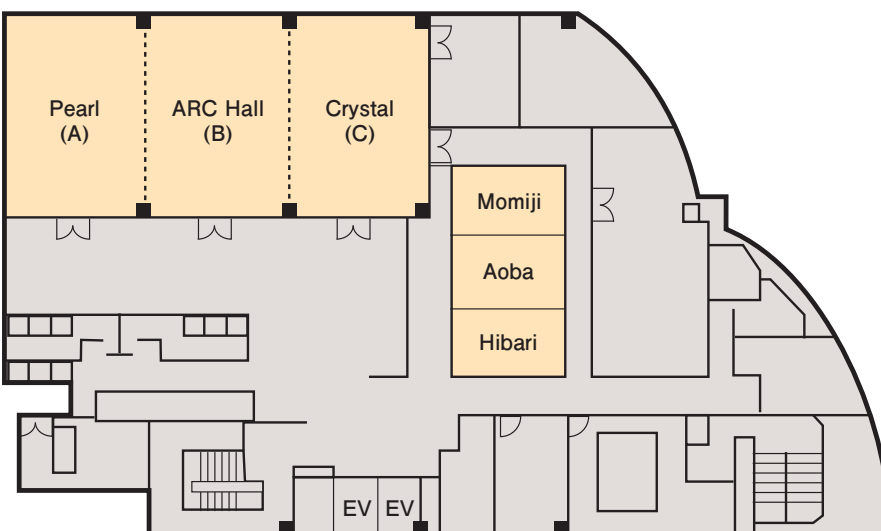

Special Features

28 mins. by JR Rapid Airport Express from New Chitose Airport Station, and 8 mins. from JR Sapporo Station to Shin-Sapporo Station. 18 mins. from Odori Subway Station to Shin-Sapporo Subway Station, which is connected to the hotel. The hotel is also connected to the bus terminal, where local buses such as JR Bus, Chuo Bus and Yutetsu Bus depart and arrive.

Facilities/Notes

Main Facilities

[ARC Hall] ARC Hall may be divided into 3 rooms, A, B and C. Aoba may also be divided into 3 rooms, Momiji (15 tatami-mat room), Aoba (15) and Hibari (12).

Main Equipment for Loan or Rent

Monitoring TV, screen, white board, OHP, slide projector, karaoke, microphones, etc.

Other Facilities

- Convenience store (open 24 hours a day)
- The biggest shopping mall in Hokkaido, Sunpiazzza; Qualite Prix Shin-Sapporo; AEON; Duo 1&2 is on the same property.

Service

Internet Usage

Free internet access

Management Support



Credit Cards Accepted



Large-scale
facilities in
suburban
areas

Sapporo Comprehensive Learning Center (Chieria)

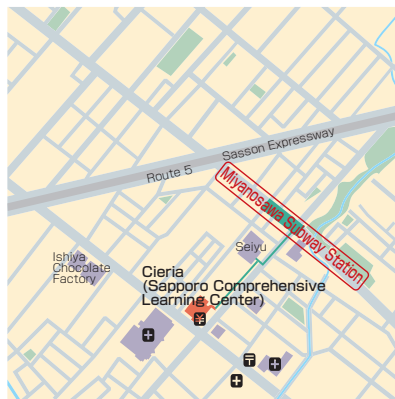

●Address...1-10, Miyanosawa 1-jo, 1-chome, Nishi-ku, Sapporo

●Tel...+81-11-671-2200

●Fax...+81-11-671-2233

●URL...<https://chieria.slp.or.jp/>

●Access

[Subway] Directly connected to Miyanosawa Subway Station on the Tozai Line

[Taxi] 25 mins. ride from Sapporo JR Station

●Parking

635 spaces, shared with Miyanosawa Seiyu Store. One hour free. One additional hour free if stamped by the parking validation machine in Chieria.

Convention Rooms

Name	Area (m ²)	Ceiling	Floor load	Dinner (people)	Buffet (people)	School (people)	Theater (people)	Basic rate (¥)
●Hall	[1F] 1,763.8						436	(106,900)
●Music Studio 1- studio control room [1F]	71.2							(8,100)
●Performance Studios 1・2 [1F]	161.8							(16,600)
●Large Training Room [2F]	197.0					108		(18,300)
●Computer Training Room [3F]	141.5					30		(9,600)
●Visual Studio	[5F] 176.4							(16,600)
●Lecture Hall	[6F] 318.3					210		(29,700)
●Japanese Room/ Tea Room [6F]	79.8					20		(6,200)

Tax included. For figures in parentheses, please see information at right. Please contact facilities directly for specific rates.

Hotel accommodation

Guestroom type	No. of rooms	No. of people	Notes
No accommodation facilities.			

Restaurants and Bars

Type	Number	Capacity	Notes
●Tea Lounge	1	70	

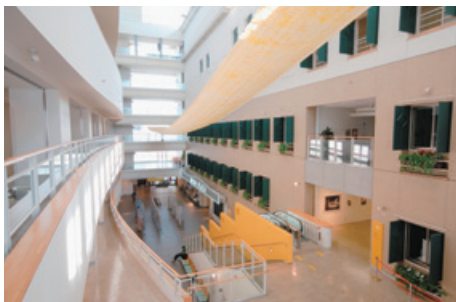

Main Floor Plan [1F]

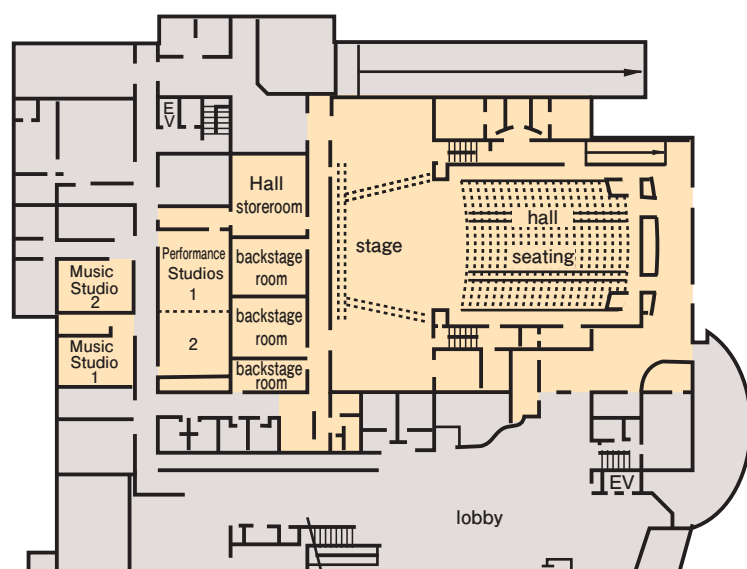

Special Features

A wide variety of halls and music studios etc. are available.

Facilities/Notes

Room Notes

Each rental room can be rented for the morning time period, afternoon, evening, or all day. (The list at left shows the rates for all-day rental. The Hall's rental rate at left is for a weekday.)

For-profit companies and entities will be charged an additional 100% of the fee. Also, in cases where entrance fees are charged for the event, an additional charge will be applied, varying depending on the amount of the entrance fee charged.

The inside of the building is decorated with an art exhibit by nine different artists, entitled "Looking at Time".

Main Equipment for Loan or Rent

Projector, microphones, panels, etc.

Main Facilities

[Hall] A 436-seat multi-purpose hall.

[Music Studio 1 - studio control room] A studio equipped with soundproof facilities and recording equipment.

[Performance Studios 1・2] Used for practice of stage and musical performances. Contains audio-

visual equipment and a lighting system.

[Large Training Room] Audio-visual equipment, projector, two suspended TVs installed.

[Japanese room / Tea room] Tea ceremony set (excepting consumable goods).

Service

Internet Usage



Language Services

English signage within the building.

Universal Accessibility



Tsudome (Sapporo Community Dome)

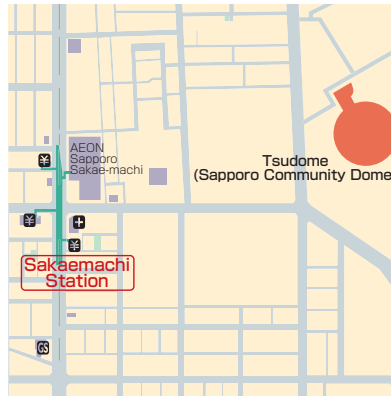

- Address...881-1, Sakae-machi, Higashi-ku, Sapporo
- Tel...+81-11-784-2106
- Fax...+81-11-784-2107
- URL...<https://www.shsf.jp/tsudome/>
- Access
- [Subway] 10 mins. on foot from Sakae Machi Station on the Toho Line
- [Bus] Use bus stop Tsudome-Mae on the Sakae Machi Kyouiku-dai Line
- [Taxi] 15 mins. ride from Sapporo Station
- Parking
- 306 spaces, free of charge.
- Wheelchair-accessible spaces are available.

Convention Rooms

Name	Area (m ²)	Ceiling	Floor load	Dinner (people)	Buffet (people)	School (people)	Theater (people)	Basic rate (¥)
● Indoor Arena	11,484	39.5m						(300,000)

Please contact the facility for rates.

Hotel accommodation

Guestroom type	No. of rooms	No. of people	Notes
No accommodation facilities			

Restaurants and Bars

Type	Number	Capacity	Notes
● Restaurant	1	43	
● Shop	1		

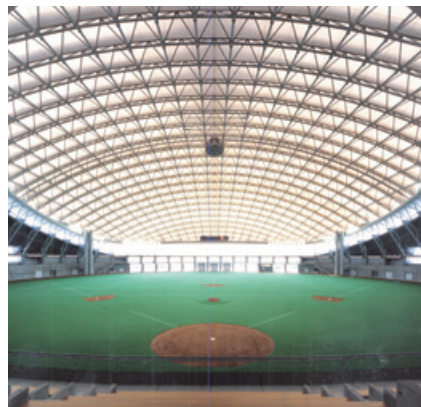

Main Floor Plan [1F]

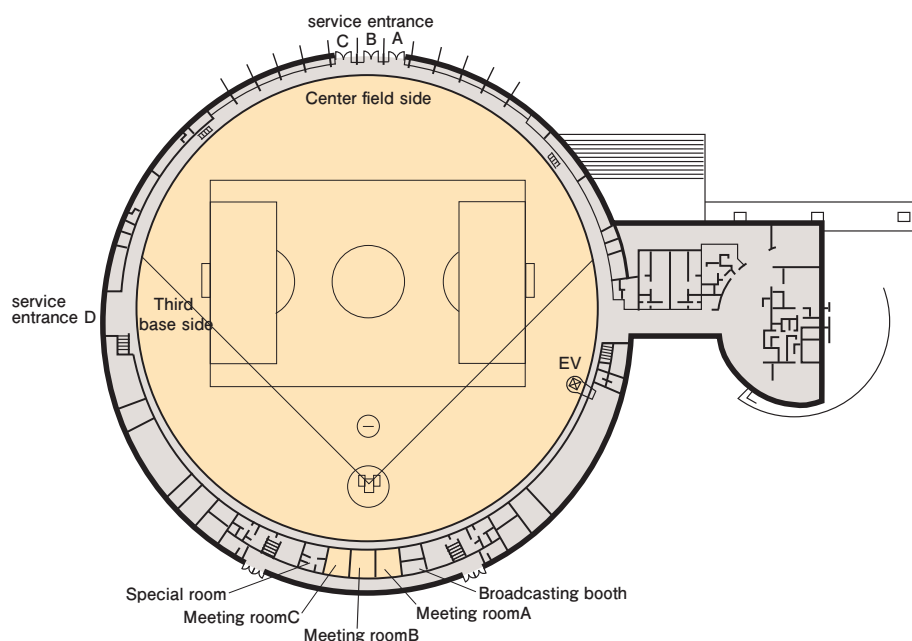

Special Features

The floor of this indoor area is covered with artificial turf. To allow natural light into the dome, the roof is made of Teflon, the same material used in the Tokyo Dome.

Facilities/Notes

Room Notes

Basic rates apply for conventions, ceremonies and other gatherings, from 9 am to 9 pm on weekdays. The rates vary depending upon event. (Amateur rate is 80,000 yen from 9 am to 9 pm on weekdays, and professional events or merchandise sales are 900,000 yen from 9 am to 9 pm on weekdays) Heating, lighting, housing and other utility costs are not included.

Please contact the Sapporo Community Dome directly for details.

Main Facilities

Regarding floor weight capacities, the static load is 3.5 t/m² (within 72 hr.) and the dynamic load is 67 t/m² (within 5 min.). Three service entrances (A, B, C) are behind center field, and one (D) is behind third base.

Service entrances A and C: 3.6 m wide × 3.7 m high

Service entrance B: 3.6 m wide × 3.4 m high

Service entrance D: 3.1 m wide × 3.3 m high

Main Equipment for Loan or Rent

Folding chairs, long tables, exhibition panels, podium, flower stand, movable stage, polypropylene foam sheet, tarpaulin sheet (free of charge), electronic information board.

Other Facilities

● Conference rooms ● meeting rooms ● VIP Special room ● broadcasting booth

Service

Universal Accessibility



Elevator for disabled guests (within the indoor arena).

Large-scale facilities in suburban areas

Glass Pyramid in Moerenuma Park (HIDAMARI)



● Address...1-1, Moerenuma Koen, Higashi-ku, Sapporo

● Tel...+81-11-790-1231

● Fax...+81-11-792-2595

● URL...<http://moerenumapark.jp>

● Access

[Subway & Bus]

5 mins. walk from JR Sapporo Station to Sapporo Subway Station on the Toho Line. 5 mins. subway ride to Kanjo-dori Higashi Subway Station on the Toho Line. From Gate No. 1 at the bus terminal, take the bus no. "Higashi 69" bound for "Ainosato Kyouiku Daigaku-eki" or "Higashi 79" bound for "Nakanuma Shogakko-dori", to the stop "Moerenuma Koen Higashi-guchi".

[Taxi] 40 mins. from JR Sapporo Station (approximately 4,000yen)

● Parking

1,500 spaces (summer), 100 spaces (winter), free of charge

Convention Rooms

Name	Area (m ²)	Ceiling	Floor load	Dinner (people)	Buffet (people)	School (people)	Theater (people)	Basic rate (¥)
● Atrium 1	[1F] 864		360kg/m ²				350	16,600
● Atrium 2	[2F] 587		360kg/m ²				250	13,600
● Space 1	[1F] 192	4.8m	250kg/m ²			40	120	7,600
● Space 2	[2F] 267	3.5m	250kg/m ²			50	150	10,600

Morning (9am-noon), afternoon (1-5pm), evening (6-9pm), all day (9am-9pm). Rates are subject to change. Please contact each facility directly for specific rates.

Hotel accommodation

Guestroom type	No. of rooms	No. of people	Notes
No accommodation facilities			

Restaurants and Bars

Type	Number	Capacity	Notes
● Restaurant	1	47	French restaurant serves course meals
● Bar			
● Tea Lounge			
● Shop	1		For take out

Main Floor Plan

[1F]

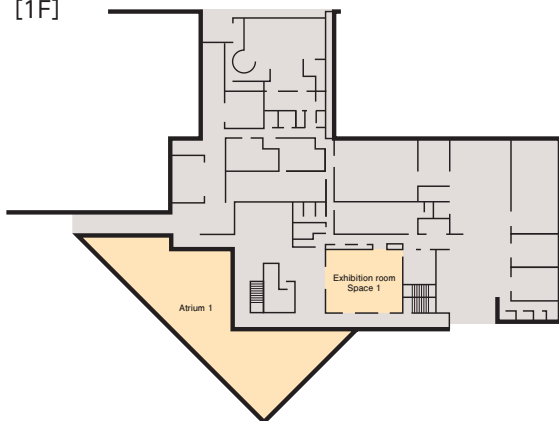

[2F]

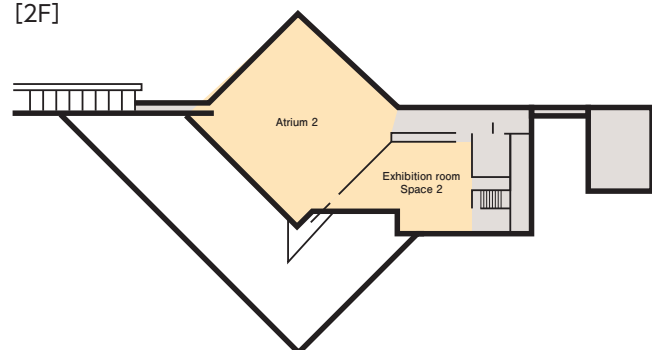

Special Features

Moerenuma Park is a vast art park designed by world-famous sculptor Isamu Noguchi and has been attracting a lot of attention due to its unprecedented scale since its grand opening in 2005. The park is home to 15 sports and other facilities, and the Glass Pyramid is well known as its symbolic structure. Visitors can experience the beauty of the 32-meter high glass top view from inside of the pyramid. It is warm in winter, and many visitors enjoy it as a recreation area.

The Glass Pyramid also features four facilities: Space 1 is fully equipped with visual devices such as projectors and can be used for conferences; Space 2 is open-structured and suitable for exhibitions and workshops; and Atrium 1 and 2 are available for concerts and wedding ceremonies.

Facilities/Notes

Main Equipment for Loan or Rent

Chairs, desks, writing kit (with charge), round table, full-length mirror, rope partition, and signature stand are available throughout the entire facility.

Audio system, video player, projector with screen, and microphones are for rental in Space 1.

Service

Language Services

English signage is available. Facility guides are available in English, Chinese and Korean.

Management Support

Due to the unique structure of the facility, we advise the hosts of events and conventions to plan and meet thoroughly in advance.

Universal Accessibility



Large-scale
facilities in
suburban
areas

CHÂTERAISE Gateaux kingdom SAPPORO



● Address...132, Higashibarato, Kita-ku, Sapporo
● Tel...+81-11-773-2211
● Fax...+81-11-773-0758
● URL...<http://www.gateauxkingdom.com>
● E-mail...banquet-reservation-gks@gateauxkingdom.com

● Access

[Taxi] 30 mins. from JR Sapporo sta.
(approximately 3,500yen)

[Bus] Free shuttle bus service is available from the group bus stop at the north exit of Sapporo Station via Asabu Subway Station on the Namboku Line (approx. 40 min.).
For the operation schedule, please see the website.

● Parking

Free (2,000 cars)

Convention Rooms

Name	Area (m ²)	Ceiling	Floor load	Dinner (people)	Buffet (people)	School (people)	Theater (people)	Basic rate (¥)
● Cabernet	[1F] 1,357	7m		800	1,300	700	1,600	2,300,000
● Sunset	[2F] 185	2.7m		70	100	70	120	240,000
● Chardonnay	[3F] 1,415	7m		850	1,400	750	1,700	2,300,000
● Muscat	[3F] 219	3m		80	120	100	180	350,000
● Pione	[3F] 117	2.8m		30	40	30	40	200,000
● Delaware	[3F] 70	2.7m		20	30	20	30	130,000

Basic rates are for normal use for 8 hours, tax included. Rates may change. Please contact each facility directly for specific rates.

Hotel accommodation

Guestroom type	No. of rooms	No. of people	Notes
● Japanese-style	19	90	6 Japanese + twin rooms included
● Suite	21	44	
● Single	27	27	
● Twin	194	388	
● Other	23	46	Double
● Total	284	595	

Restaurants and Bars

Type	Number	Capacity	Notes
● Restaurant	4	600	Japanese, Western, Chinese food, Teppanyaki (a style of Japanese cuisine that uses an iron griddle to cook food.)
● Bar	1	20	
● Tea Lounge			
● Shop	3		1 gift shop, 2 cake shops

Main Floor Plan

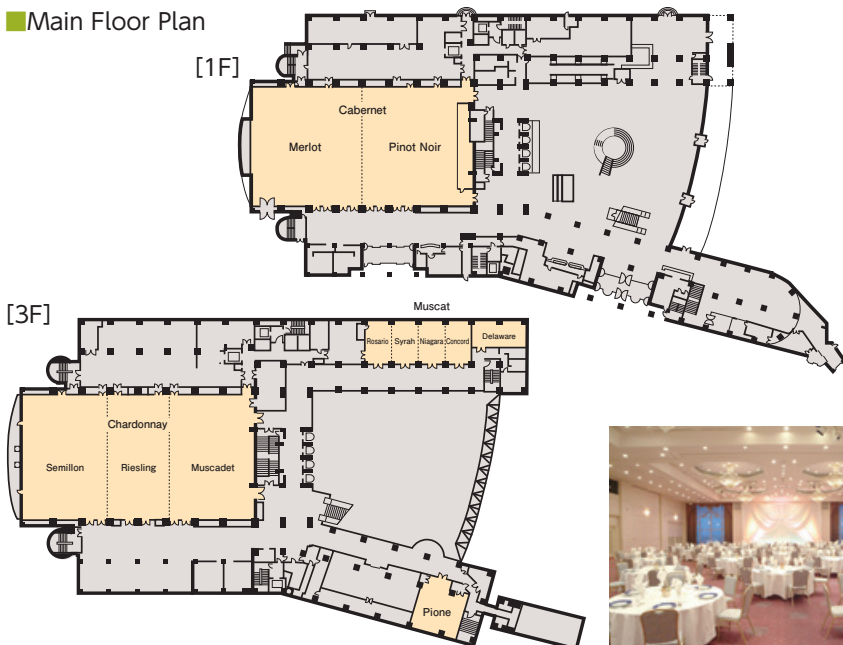

Special Features

This is a resort hotel where guests can enjoy dining (restaurants, banquets), recreation (pool & spa) and relaxation.

Facilities/Notes

■ Main Facilities

[Cabernet] 280-inch screen, video projector, 300 rollback sheets

[Chardonnay] 250-inch screen, video projector

[Muscat] a white board which can be stored

[Pione] 100-inch screen

[Delaware] a white board which can be stored

■ Other Facilities

Pool & Spa (Fairy fontaine), in the hotel (beauty salons, a dressing room, a chapel, shrine, sweets factory Fantanniver)

■ Management Support

300 rollback sheets, stair type movie seats

Service

■ Internet Usage



■ Language Services



■ Management Support



■ Universal Accessibility



■ Credit Cards Accepted

