

Suburban facilities

Kiroro Tribute Portfolio Hotel Hokkaido	71
Grand Park Otaru	72
Rusutsu Resort Hotel & Convention	73
The Windsor Hotel TOYA Resort & Spa	74
Hotel Nidom	75
Hilton Niseko Village	76
ANA Crowne Plaza Hotel Chitose ...	77

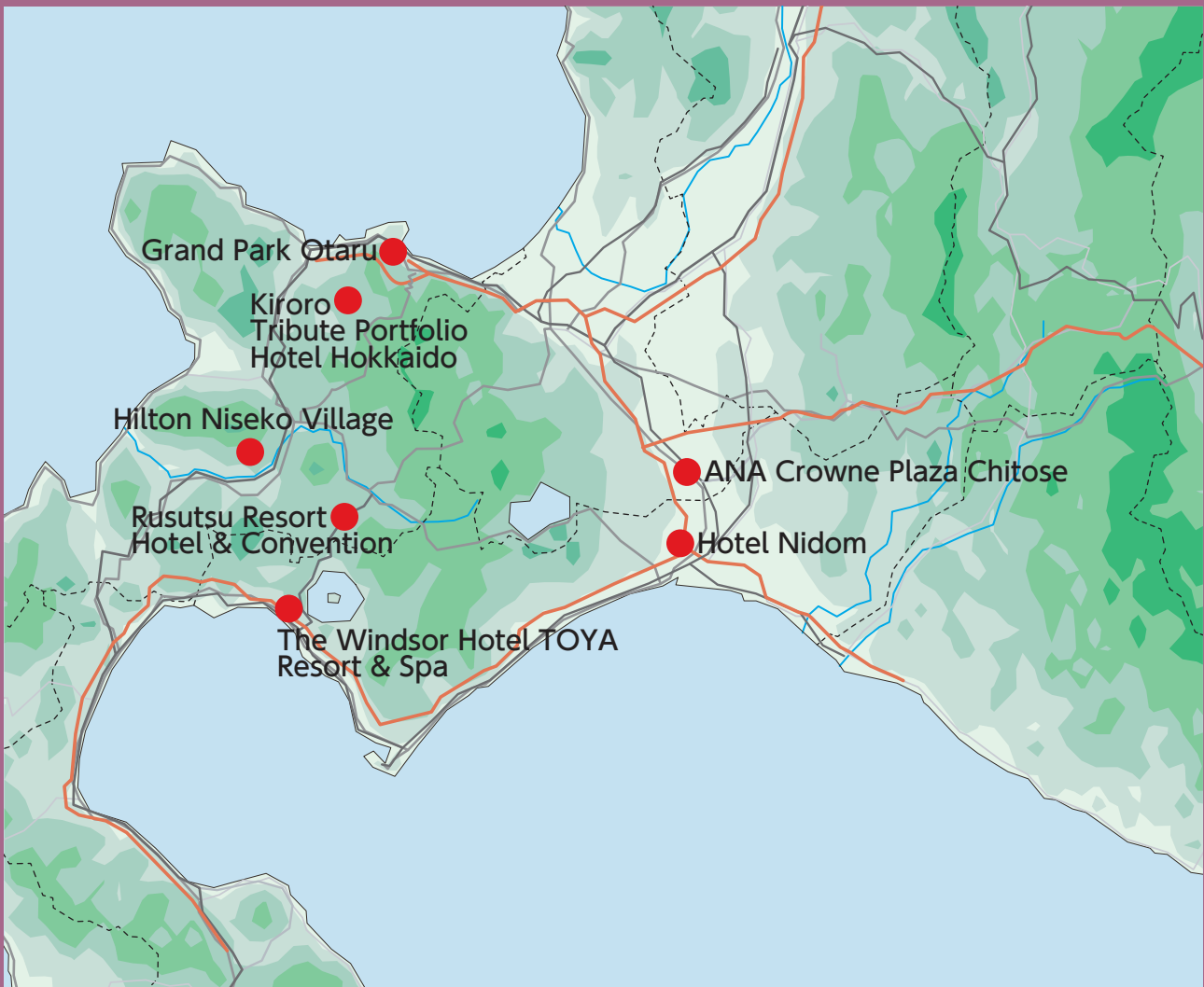

Suburban facilities

The Kiroro, a Tribute Portfolio Hotel, Hokkaido

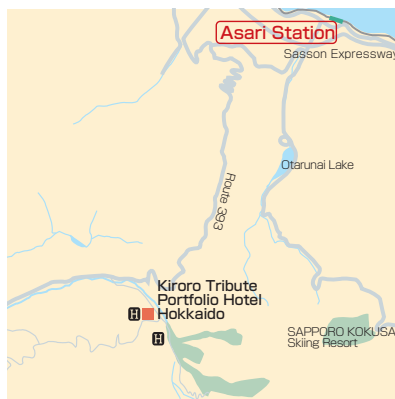

- Address...128-1, Aza Tokiwa, Akaigawa, Yoichi-gun
- Tel...+81-135-34-7111
- URL...<https://www.kiroro.co.jp/>
- Access
- [Bus] 40 mins. from JR Otaru Chikko Station. Bus Terminal (Bound for Kiroro Resort)
- [Taxi] 40 mins. from JR Otaru Station. (approximately 7,000yen)
- Parking
- Free (outdoor parking)
- For a fee (indoor parking)

Convention Rooms

Name	Area (m ²)	Ceiling	Floor load	Dinner (people)	Buffet (people)	School (people)	Theater (people)	Basic rate (¥)
● Large Hall [2F]	1,125	6.3m		300	200	700	900	1,500,000
● Medium-sized Hall [2F]	180	3.4~3.7m		56	45	80	120	230,000
● Small Hall [2F]	80	3.4m		32	16	40	50	100,000
● Meeting Room [3F]	40	2.4m				18	30	50,000

Basic rates are for 8 hours' usage, tax and service charge not included. Please contact each facility directly for specific rates.

Hotel accommodation

Guestroom type	No. of rooms	No. of people	Notes
● Japanese-style			
● Suite	8	20	Five types
● Single			
● Twin	272	810	Up to four people per room.
● Other			
● Total	281	830	Total accommodation capacity

Restaurants and Bars

Type	Number	Capacity	Notes
● Restaurant	12		Japanese-style pub and food, char-grilled style, Japanese cuisine, Italian, buffet-style
● Bar Lounge	3		
● Shop	3		Convenience store, Gift shop, Convenience store, gift shop, sports apparel shop

Main Floor Plan [1F]

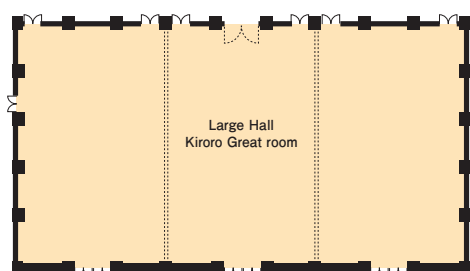

Special Features

Located some 28 kilometers from Otaru, the Kiroro resort is a tourism base in the Shiribeshi district. The hotel welcomes guests as a ski resort during winter and as a relaxing resort in a natural environment during summer. It also provides halls and meeting rooms to serve a wide array of events including various parties, seminars, lectures and ceremonies.

Facilities/Notes

Room Notes
There are fixed rates for each site, from 2 hours' use to all-day use. Large, medium-sized and small halls. Separate rates are set for exhibitions. Service charges and tax are not included. Signage production for the size 600cm x 1800cm starts from 30,000 yen. For shuttle bus service between Sapporo and Otaru, please contact us.

Main Facilities
[Large Hall "Ballroom"] 2/3 size partition: 750m² with a capacity of 240 people; 1/3 size partition: 375m² with a capacity of 120 people. [Medium-sized Hall] 2 halls. [Small hall] 2 halls. [Meeting room] 4 rooms available.

Main Equipment for Loan or Rent
Stage (2,400cm x 1,200cm), white board, screen, georgette, gilded folding screen, microphone, PA, karaoke, Video deck, TV, platform, lectern, projector (can be used with a computer).

Other Facilities
Restaurants, Hot Spring bath, swimming pool, shops, tennis court, karaoke rooms, Fitness center, ski resort.

Service

● Internet Usage
Wi-Fi can be used in the banquet rooms.

● Universal Accessibility
WC

● Credit Cards Accepted

AMEX VISA JCB Master Diners

J-Debit Edy IC transportation cards are also accepted.

Grand Park Otaru



- Address...11-3, Chikko, Otaru
- Tel...+81-134-21-3111
- Fax...+81-134-21-3322
- URL...<https://grandparkotaru.com>
- E-mail...info.gpot@parkhotelgroup.com
- Access
 - [JR] 5 min. walk from JR Otaru Chikko Station.
 - [Taxi] 30 mins. from JR Sapporo Station (approximately 8,000yen)
- Parking
 - 132 spaces
 - 1,100yen/day for hotel guests 5-hour free parking for visitors of restaurants and parties

Convention Rooms

Name	Area (m ²)	Ceiling	Floor load	Dinner (people)	Buffet (people)	School (people)	Theater (people)	Basic rate (¥)
● Jurin [5F]	682	7m		400	550	450	708	880,000
● Jukai [5F]	338	7m		150	260	192	300	440,000
● Juhyo [5F]	338	7m		150	260	192	300	440,000
● Ryusei [5F]	242	4m		120	180	144	220	316,800
● Ginga [5F]	242	4m		120	180	144	220	316,800
● Umi [5F]	116	3.4m		60	80	72	110	158,400
● Tsuki [5F]	81	3.4m		40	55	54	80	123,200
● Hoshi [5F]	73	3.3m		40	45	48	60	105,600

Basic rates apply to charges for 8 hours of normal use. Tax is not included. Please contact each facility directly for specific rates.

Hotel accommodation

Guestroom type	No. of rooms	No. of people	No. of people
● Japanese-style	6		
● Suite	5		
● Single			
● Twin	239		
● Other	46	2 wheelchair-accessible rooms with 2 beds are available.	
● Total	296	723	

Restaurants and Bars

Type	Number	Capacity	Notes
● Restaurant	3		
● Bar	1		
● Tea Lounge	1		
● Shop	1		

Main Floor Plan [5F]

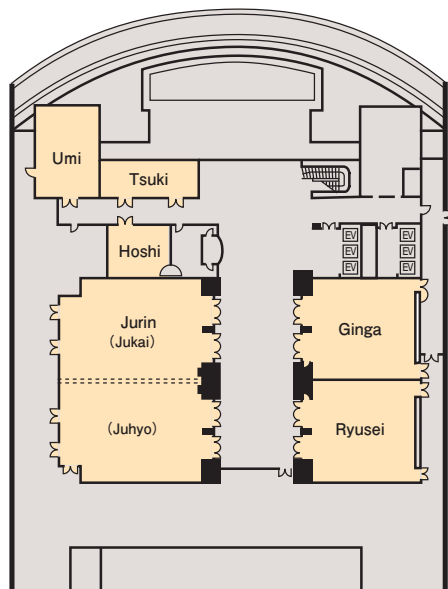

Special Features

This is a seaside resort that is approximately 65 minutes from New Chitose Airport by JR. The hotel is available for leisure as well as every type of reception, convention and conference. Convention venues, overlooking beautiful marinas and panoramic views of Ishikari Bay, are equipped with well-maintained facilities. Experienced staff welcome guests with first-class hospitality.

Facilities/Notes

- Room Notes
 - Rates shown are based on the charge for an exhibition lasting 8 hours between 9am and 9pm. Other rates are available for conference use, banquet use, etc. Tax is not included.
- Main Facilities
 - [Jurin]Stage, music equipment, lighting equipment.
- Main Equipment for Loan or Rent
 - Portable dance floor, sound system, karaoke, screen, Projector, simultaneous interpretation, video deck, flip board, Podium, white board, microphone, etc. (Please note some items carry a surcharge)
- Other Facilities
 - In addition to the halls listed at left, the multi-purpose hall "Sora" (110m²), and meeting rooms, "Oshidori" "Kotobuki" and "Suehiro" (53meach) are available. There is an outlet shopping mall in the area as well as a nearby shopping mall which contains a sports club with public bath, movie theaters, bookstores, restaurants, and department stores.
- Service
 - Internet Usage
 -
 - Language Services
 -
 - Universal Accessibility
 - 2 wheelchair-accessible guest rooms with 2 beds
 - Credit Cards Accepted
 -

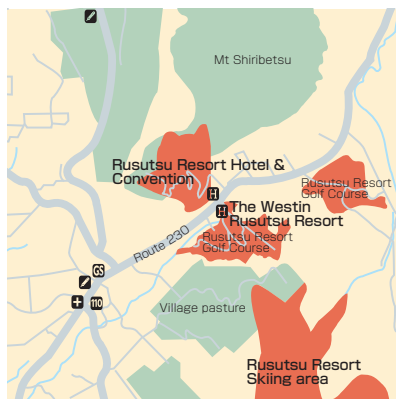

- Address...3, Aza Izumikawa, Rusutsu, Abuta-gun
- Tel...+81-136-46-3111
- Fax...+81-136-46-3229
- URL...<https://www.rusutsu.co.jp/>
- E-mail...info@rusutsu.co.jp
- Access
 - [Car] 90 mins. from Sapporo
 - [Bus] 60 mins. from JR Kutchan Station to Rusutsu Resort
- Parking
 - Summer - 2,000 spaces. Winter - 3,000 spaces.
 - 500yen on Saturday, Sunday, national holidays and during school summer break Free for other days and seasons

Convention Rooms

Name	Area (m ²)	Ceiling	Floor load	Theater (people)	School (people)	Dinner (people)	Buffet (people)	Basic rate (¥)
● Crescent Hall [2F]	588			560	315	350	456	1,100,000
● Convention Hall 1 [4F]	300			240	150	150	180	440,000
● Convention Hall 2&7 [4F]	42			32	24	20	24	110,000
● Convention Hall 3&5 [4F]	72			72	48	50	60	165,000
● Convention Hall 6 [4F]	105			128	72	70	84	220,000
● Convention Hall 18 [4F]	390			414	240	240	288	660,000

Basic rates apply to charges for 8 hours of normal use. Tax is not included. Please contact each facility directly for specific rates.

Hotel accommodation

Guestroom type	No. of rooms	No. of people	Notes
● Japanese-style	17	68	
● Suite	224	1,084	
● Single			
● Twin	306	918	
● Triple·Quadruple	194	776	
● Other	53		
● Total	883	4,000	

Restaurants and Bars

Type	Number	Capacity	Notes
● Restaurant	8		
● Bar	1		
● Tea Lounge	2		
● Shop	14		

Main Floor Plan

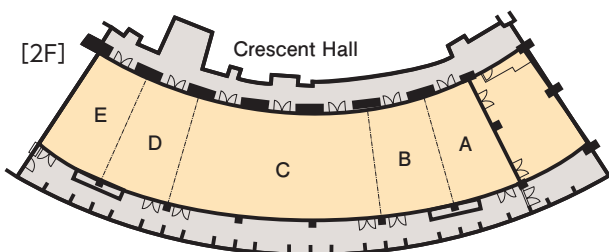

[4F]

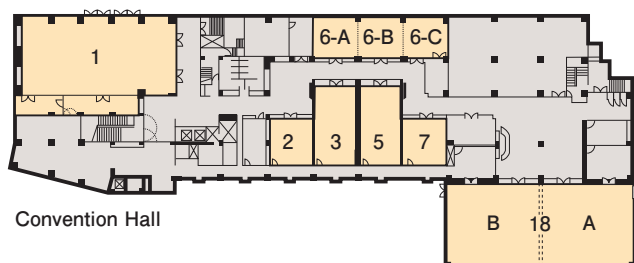

Special Features

Rusutsu's convention facilities can accommodate the various demands of large and small conferences, seminars, workshops, parties, exhibitions and wedding ceremonies. The resort hotels such as Rusutsu Tower, Rusutsu Resort Hotel&Convention welcome *MICE guests. (*Meeting, Incentive Travel, Convention, Exhibition/Events)

Facilities/Notes

- Room Notes
 - Golf courses, amusement park, and ski resort in winter are available.
- Main Equipment for Loan or Rent
 - LCD projector, karaoke, microphone, white board, and so on.
- Multilingual
 - Chinese, Korean, English
- Other Facilities
 - Amusement park, golf courses, park golf range, swimming pool, tennis court, ski resort, sports gym.

Service

- Internet Usage
 - Wi-Fi, LAN
- Language Services
 - Chinese, Korean, English
- Universal Accessibility
 -
- Credit Cards Accepted
 -

The Windsor Hotel TOYA Resort & Spa



- Address...336, Shimizu Toyoko-cho, Abuta-gun
- Tel...+81-142-73-1111
- Fax...+81-142-73-1191
- URL...<https://www.windsor-hotels.co.jp>
- E-mail..reservation@windsor-hotels.co.jp
- Access
[JR·Bus] 40 mins. by shuttle bus from JR Toya Station on the Mutoran Line
- Parking
241 spaces, free of charge

Convention Rooms

Name	Area (m ²)	Ceiling	Floor load	Dinner (people)	Buffet (people)	School (people)	Theater (people)	Basic rate (¥)
● The Windsor Hall [B1F]	870	6m		540	850	540	1,100	
● Marquis [B1F]	83	2.7m		32	50	45	70	
● Banquet Lobby [B1F]	314	16m			370			
● Duke [1F]	235	2.6m		110	160	110	220	
● Earl [1F]	100	2.6m		32	55	50	75	
● Viscount [1F]	42	2.4m				15	25	
● Baron [1F]	62	2.4m		24	35	30	50	

Please contact the facility for rates.

Hotel accommodation

Guestroom type	No. of rooms	No. of people	Notes
● Japanese-style	2		
● Suite	112		
● Superior Suites	272		
● Total	386		

Restaurants and Bars

Type	Number	Capacity	Notes
● Restaurant	7		
● Bar	1		
● Tea Lounge	1		
● Boulangerie	1		
● Shop	2		

Main Floor Plan [1F]

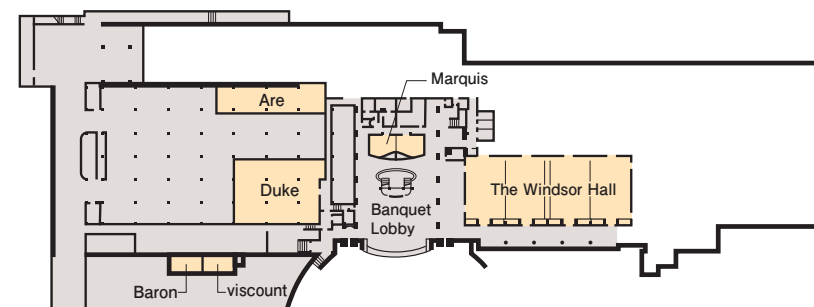

Special Features

Surrounded by breathtaking nature, this internationally-renowned resort hotel stands on a hilltop overlooking Lake Toya and Uchiura Bay. Guests can enjoy various cuisines at Michel Bras Toya Japon, a French restaurant that garnered two stars in the Michelin Hokkaido 2017 Special Edition, at Windsor Out Of Africa, which is a one-star teppanyaki restaurant, and at many other restaurants, and other activities are also available at this extended-stay hotel.

Facilities/Notes

- Main Equipment for Loan or Rent
Slide projector: 50,000yen per day. 180-inch screen: 25,000yen per day.
- Other Facilities
Chapel, golf courses, tennis courts, ski resort, spa, hot spring bath, swimming pool, sauna, jet bath, shopping mall, non-smoking room, laundry service, room service, massage, baby-sitting service, parcel delivery, hair salon.

Service

- Internet Usage
- Language Services
- Management Support
- Universal Accessibility
- Credit Cards Accepted

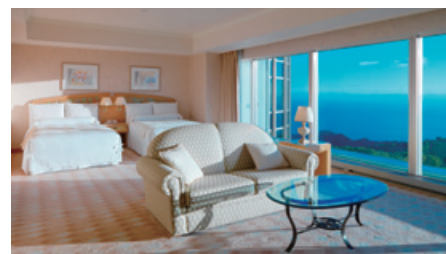



- Address...430, Aza Uenae, Tomakomai
- Tel...+81-144-55-8000
- Fax...+81-144-55-8121
- URL...<https://www.nidom.com/>
- E-mail...hotel@nidomresort.jp
- Access
- [Bus] Bound for Uttonai Danchi
- [Taxi] from New Chitose Airport and from JR Tomakomai Station
- Parking
- 200 spaces, free of charge

Convention Rooms

Name	Area (m ²)	Ceiling	Floor load	Dinner (people)	Buffet (people)	School (people)	Theater (people)	Basic rate (¥)
● Niharu [1F]	300			160	180	180	200	165,000
● Konkanipe [2F]	100			40	50	50	60	77,000
● Topeni [B1F]	110			50	50	50	60	55,000

Basic rates apply to charges for 2 hours of normal use. Service charges and tax are included. Please contact each facility directly for specific rates.

Hotel accommodation

Guestroom type	No. of rooms	No. of people	Notes
● Japanese-style			
● Suite			
● Single			
● Twin			
● Other	29	148	25 cottages with capacity of 4 people, 4 cottages with capacity of 8-12 people
● Total	29	148	

Restaurants and Bars

Type	Number	Capacity	Notes
● Restaurant	3	180	Ninkule: 80 seats, Kinkin-tei: 80 seats, Tokisata: 20 seats
● Bar			
● Shop	1		

Main Floor Plan [1F]

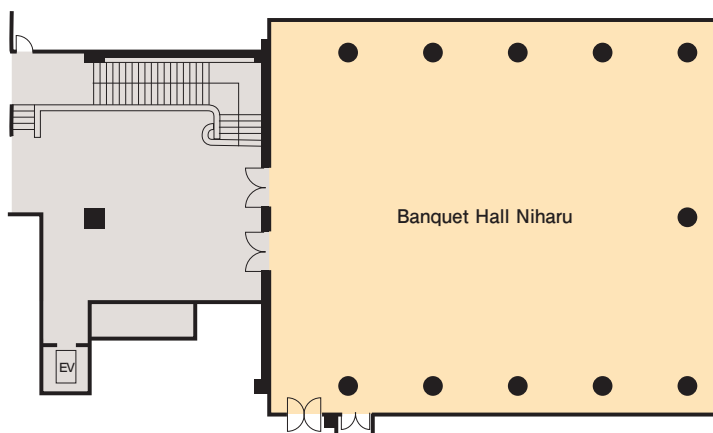

Special Features

Blessed with the natural environment of Hokkaido, Nidom can be found in a vast forest of five million square meters and offers facilities where guests can appreciate the splendor of nature. Situated 15 minutes from New Chitose Airport, the hotel is privileged to host guests from the mainland Honshu and overseas and is proud of its internationally high level of facilities.

Facilities/Notes

- Main Equipment for Loan or Rent
PC projector, video projector, large-sized screen, and so on.
- Other Facilities
Churches, golf courses
- Management Support
200 free parking spaces are available onsite.

Service

- Credit Cards Accepted



Hilton Niseko Village



- Address...Higashiyama Onsen, Niseko-cho, Abuta-gun
- Tel...+81-136-44-1111
- Fax...+81-136-44-3224
- URL...[English]
<https://www.niseko.hilton.com>
- Access
[JR] Free shuttle bus between JR Kutchan Station
- Parking
500 spaces

Conference Rooms

Name	Area (m ²)	Ceiling	Floor load	Dinner (people)	Buffet (people)	School (people)	Theater (people)	Basic rate (¥)
● Hokkaido	[3F] 820	46m		400	800	420	900	800,000
● Annupuri	[3F] 300	3.3m		160	260	170	280	400,000
● Higashiyama	[3F] 250	3.3m		130	230	110	180	320,000
● Sakurasou	[3F] 30	3.3m		18		12	25	64,000
● Komakusa	[3F] 30	3.3m		18		12	25	64,000

Basic rates apply to charges for all day use. Tax and service charges not included.

Hotel accommodation

Guestroom type	No. of rooms	No. of people	Notes
● Suite	1	4	
● Panorama	11	44	
● Twin	375	1,222	
● King	119	357	
● Total	506	1,627	

Restaurants and Bars

Type	Number	Capacity	Notes
● Restaurant	5	464	
● Bar·Pub	2	129	Karaoke rooms are available.
● Lounge	1	85	
● Shop	1		



Floor Plan [3F]

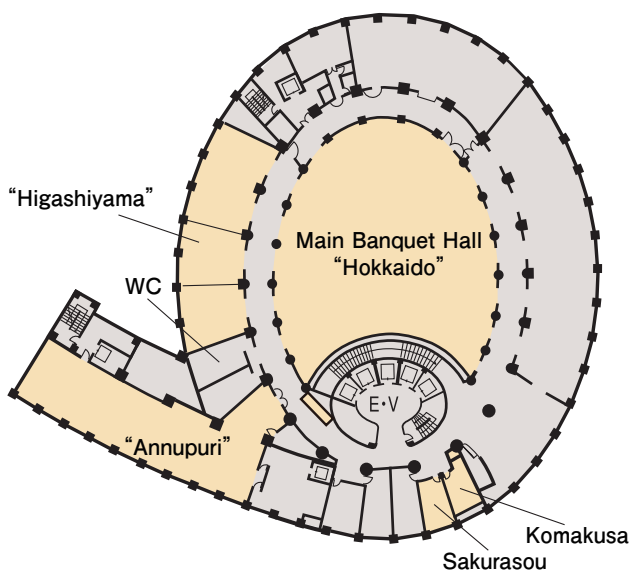

Special Features

Blessed with the beautiful nature of Niseko in Hokkaido, Hilton Niseko Village is a premier mountain resort. Looking out on the magnificent scenery of Mt. Yotei, our guests can enjoy various seasonal activities throughout the year, such as golfing, horseback riding, rafting, tennis, hiking in summer, and skiing and snowboarding on the powder snow in one of the finest ski resorts in the world. Hilton is proud to welcome our guests with the peaceful atmosphere of the lobby with a fireplace, comfortable-sized modern style guest rooms, restaurants and bars which offer international flavors, natural hot spring & a spa for relaxation. Niseko, surrounded with its rich nature, offers many hot springs, with many people visiting to enjoy them as well as to enjoy spring water from Mt. Yotei and gourmet food which uses fresh vegetables and other fresh local produce.

Facilities/Notes

Seven Conference rooms of different sizes are suitable for events such as private ceremonies, wedding receptions, group dinners, conferences, meetings and various events. The Main Banquet Hall "Hokkaido" is a thirteen-story hall with an area of 820m², which can accommodate up to 800 people for buffet parties. In addition, in "Annupuri," meetings and reception are held overlooking the beautiful nature of the resort, and "Higashiyama" may be divided into three separate rooms to meet our guests' needs. All the meeting rooms are equipped with audio visual, sound system and high-speed internet connection. Our bilingual service staff make a support team to help successful operation of meetings and events.

Other facilities and activities

Natural Hot spring, Fitness center, kids' area, karaoke (with foreign music), gift shops, ski resort, winter activities (snow mobile, ski & snowboard lessons, snow rafting etc.), golf courses, Activities in Nature "pure" (tree trekking, zip-line, cycling, jogging & walking courses, tennis, and hot-air ballooning).

Service

Internet Usage



Language Services

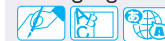

Management Support



Universal Accessibility



Credit Cards Accepted



Suburban facilities

ANA Crowne Plaza Hotel Chitose

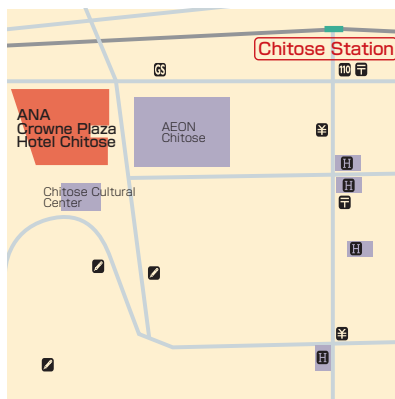

- Address...2-2-1 Hokuei, Chitose
- Tel...+81-123-22-2311
- Fax...+81-123-27-5500
- URL...<https://www.anacrowneplaza-chitose.jp/>
- Access
 - [JR] About 7 mins. walk from JR Chitose Station
 - [Car] 15 mins. drive from New Chitose Airport
- Parking
 - 90 spaces, free of charge
 - ※Parking spaces for large buses are available.

Convention Rooms

Name	Area (m ²)	Ceiling	Floor load	Dinner (people)	Buffet (people)	School (people)	Theater (people)	Basic rate (¥)
● Chitose	[2F] 1,000	6m		600	1,000	650	1,000	2,300,000
● Yufutsu	[2F] 250	3.5m		160	180	180	250	650,000
● small banquet halls (5)	[2F] 40	3m		24	30	24	40	100,000
● Sky Banquet	[11F]	60	3m	30	40	30	50	100,000
● Japanese rooms	[1F]	80		12				

Basic rates apply to charges for all day use. Service charges and tax are not included. Rates may change. Please contact each facility directly for specific rates.

Hotel accommodation

Guestroom type	No. of rooms	No. of people	Notes
● Suite	2	4	
● Single	160	160	
● Twin	209	418	Rooms for three guests are available.
● Double	67	134	
● Total	438	716	

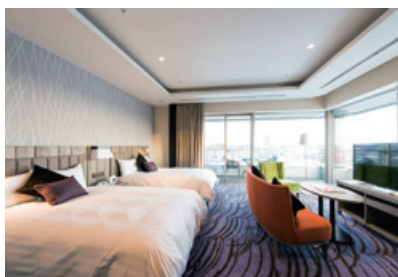

Special Features

This hotel is a 15-minute drive from New Chitose Airport, and has excellent access to Sapporo, Lake Shikotsu and other sightseeing spots, and famous golf courses. With a large convention room covering an area of 1,000 m² and 438 guestrooms, the hotel is one of the largest in Hokkaido. It is recommended for incentive trips that cover sightseeing spots and activities unique to Hokkaido. There are five convention rooms that are different in area and style, which can be divided into up to 15 spaces depending on the number of people and the use. At Haskap the Garden on the first floor, lunch buffets are provided every day, and are very popular with groups of guests. Our lunch buffet, offered every day at the Hasukappu the garden on the first floor, is appreciated by various groups of visitors.

Restaurants and Bars

Type	Number	Capacity	Notes
● Restaurant	3	299	Including tenant
● Bar	2	86	
● Tea Lounge			Café is within the restaurant
● Shop	1		
● Other	1	22	1 karaoke rooms·1 Mahjong room

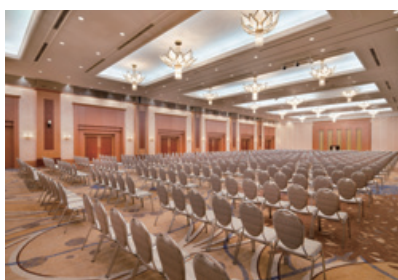

Facilities/Notes

- Room Notes
 - Halls may be divided into small rooms.
- Main Facilities
 - [Large-sized elevators] (D: 5.8m, W: 2.5m, H: 2.5m, maximum weight capacity: 4,000kg) are available to bring equipment directly from outside into the banquet hall "Chitose". This allows events such as automobile exhibitions to be held.
- Other Facilities
 - Chapel

Main Floor Plan [1F]

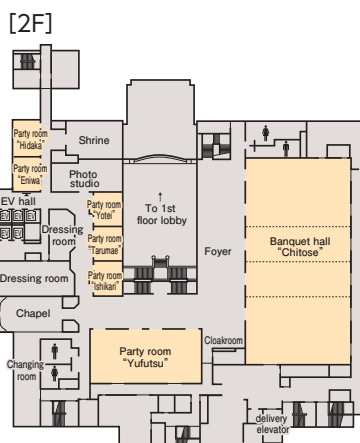
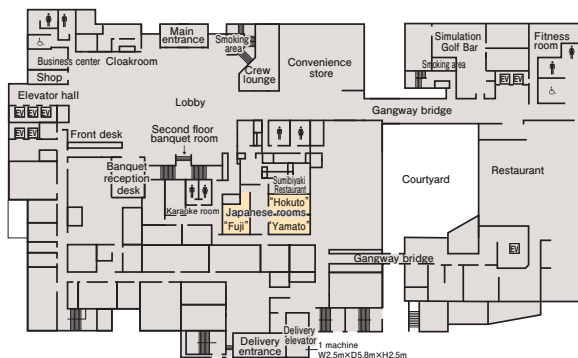

Service

- Internet Usage
 - Wi-Fi available in all floors.
- Language Services
 - Check <https://www.ihg.com>.
- Universal Accessibility
 - 1 wheelchair-accessible guestroom
- Credit Cards Accepted
 - Various credit cards are accepted.