

Makomanai Jyouzankei Area

Apa Hotel & Resort Sapporo	48
Makomanai Sekisuiheim Ice Arena...	49
Makomanai Sekisuiheim Stadium...	50
Hokkaido Seisyonen Kaikan Compass.....	51
Jyouzankei Grand Hotel Zuien.....	52
Jozankei View Hotel	53
Jozankei Hotel.....	54
Jyouzankei- Manseikaku Hotel Milione	55

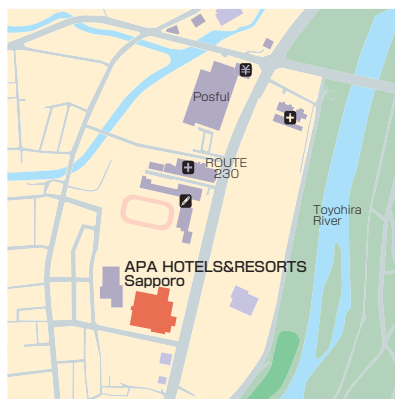

Apa Hotel & Resort Sapporo



- Address...2-chome, Kawazoe 4-jo, Minami-ku, Sapporo
- Tel...+81-11-571-3111
- Fax...+81-11-572-3461
- URL...<https://www.apahotel.com>
- E-mail...ah-rsap@apa.co.jp
- Access

[Subway] 10 mins by bus. from Makomanai Subway Station.
[Bus] Bound for Tokai Daigaku or Minaminosawa Sakimawari from Makomanai Subway Station. The bus stop is Kawazoe 5-jo 2-chome

[Taxi] 25 mins. from JR Sapporo Station, 20 mins. from Susukino Subway Station, 7 mins. from Makomanai Subway Station.

[Car] 25 mins. drive from JR Sapporo Station.

- Parking
250 spaces, free of charge.

Convention Rooms

Name	Area (m ²)	Ceiling	Floor load	Dinner (people)	Buffet (people)	School (people)	Theater (people)	Basic rate (¥)
● Large Hall (Luxe)	1,356	7m		800	1,500	1,200	2,000	576,000
● Grace	86			36	40	35	70	48,000

Basic rates are for 8 hours' usage. Tax not included. Please contact each facility directly for specific rates.

Hotel accommodation

Guestroom type	No. of rooms	No. of people	Notes
● Japanese-style			
● Suite	1	2	
● Single	107	107	
● Twin	795	1,769	Some convertible to triple
● Other			
● Total	903	1,878	

Restaurants and Bars

Type	Number	Capacity	Notes
● Restaurant	1	80	
● Shop	1		

Special Features

Located seven kilometers south of the downtown area, this spacious hotel is surrounded by nature despite its urban location. A total of 903 guestrooms are prepared for up to 1,878 guests, with convention hall Luxe easily accommodating some 2,000 guests. The lobby is also luxuriously spacious. A new large common bathing area was built in 2005. Internet access is available in all rooms. A complimentary shuttle service is provided to the downtown area at night and to Makomanai Subway Station in the morning.

Facilities/Notes

Room Notes

The large hall can be divided into 3 smaller ones.

※The convention rooms are operated by TKP Sapporo Convention Hall.
Contact: Tel 011-252-3165

Other Facilities

Non-smoking rooms (591 rooms), all the rooms have an air cleaner.

Service

Internet Usage

Wi-Fi available in all guestrooms and the lobby.

Universal Accessibility



Credit Cards Accepted



Main Floor Plan

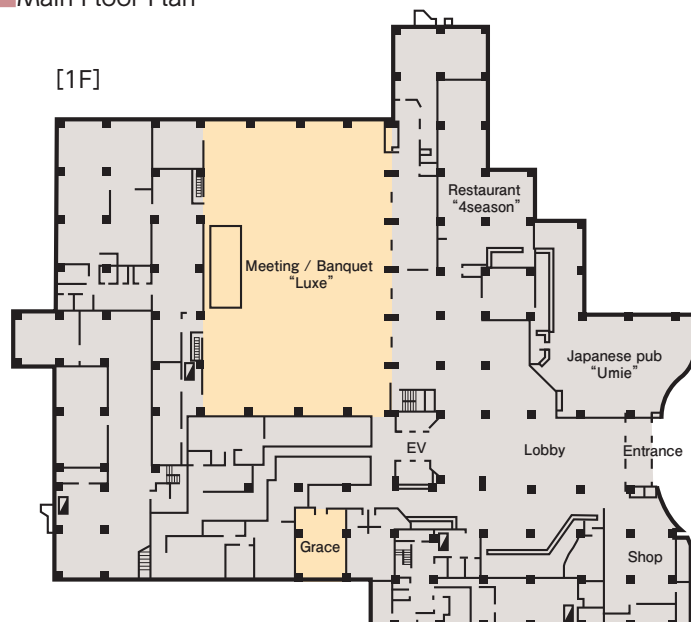

Makomanai Sekisuiheim Indoor Skating Rink

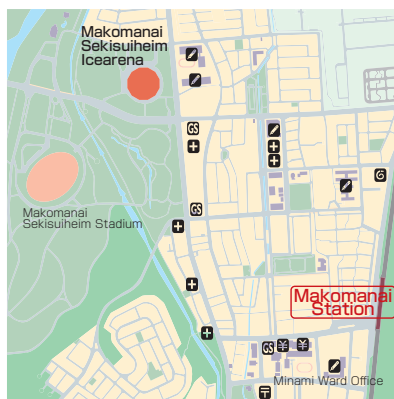

- Address...1-1, Makomanai-koen, Minami-ku, Sapporo
- Tel...+81-11-581-1972
- Fax...+81-11-581-1979
- URL...<http://www.makomanai.com>
- E-mail...icearena@makomanai.com
- Access
- [Subway] 25 mins. on foot from Makomanai Subway Station on the Nanboku Line
- [Bus] 5 mins. ride by Jotetsu Bus from Makomanai Subway Station.
- [Taxi] 30 mins. ride from JR Sapporo Station.
- Parking
- 200 spaces.

Convention Rooms

Name	Area (m ²)	Ceiling	Floor load	Dinner (people)	Buffet (people)	School (people)	Theater (people)	Basic rate (¥)
● Arena	about 2,800							6,024

Please contact the facility directly for specific rates.

Hotel accommodation

Guestroom type	No. of rooms	No. of people	Notes
No accommodation facilities.			

Restaurants and Bars

Type	Number	Capacity	Notes
● Restaurant	1	140	
● Bar			
● Tea Lounge	1	12	
● Shop			

Main Floor Plan

[1F]

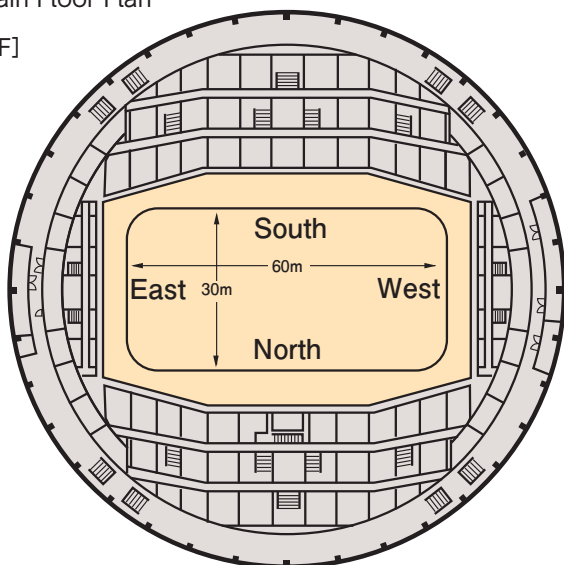

Special Features

1. This was the venue of the closing ceremony, ice hockey and figure skating events at the Sapporo Winter Olympic Games.
2. It is used for international skating competitions (ice hockey, figure skating)
3. This mammoth arena can accommodate up to 10,000 people and is versatile enough to host large rallies, other sporting events, concerts and exhibitions.
4. The arena is situated in a natural environment surrounded by lush greenery.

Facilities/Notes

- Room Notes
- 6,024 fixed seats + 4,000 movable seats.
- Rates change according to purpose and season.
- Other Facilities
- Running course ● Machine gym ● Weight training room

Service

- Universal Accessibility



Makomanai Sekisuiheim Stadium



- Address...3-1, Makomanai-koen, Minami-ku, Sapporo
- Tel...+81-11-581-1961
- Fax...+81-11-581-1962
- URL...<http://www.makomanai.com/openstadium/>
- E-mail...openstadium@makomanai.com
- Access
 - [Subway] 30 mins. on foot from Makomanai Subway Station on the Nanboku Line
 - [Bus] 6 mins. by Jotetsu Bus from Makomanai Subway Station, and 2 mins. on foot.
 - [Taxi] 30 mins. from JR Sapporo Station.
- Parking
 - 320yen for Standard vehicle, 660yen for bus, 210yen for motorcycle on Saturday, Sunday, and national holidays from April 29 to November 3.

Convention Rooms

Name	Area (m ²)	Ceiling	Floor load	Dinner (people)	Buffet (people)	School (people)	Theater (people)	Basic rate (¥)
● Main stand	3,800						7,562	109,080
● Arena	15,900							
● Stands							17,324	

See notes at right for further details about figures in parentheses. Please contact each facility directly for specific rates. Rates may change, so please contact the facility directly for specific rates.

Hotel accommodation

Guestroom type	No. of rooms	No. of people	Notes
			No accommodation facilities

Restaurants and Bars

Type	Number	Capacity	Notes
● Restaurant	1	50	Serving light foods.
● Bar			
● Tea Lounge			
● Shop	1		

Main Floor Plan

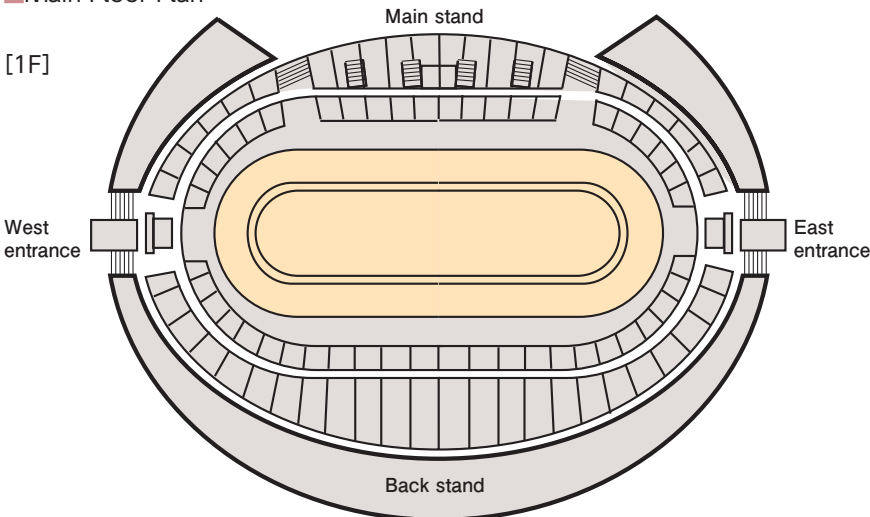

Special Features

1. This was the venue for the opening ceremony and speed skating events at the Sapporo Winter Olympic Games.
2. The venue is used for international skating competitions (speed skating)
3. This is the only large outdoor institution in Hokkaido. It is can accommodate 17,324 people.
4. The area is situated in a natural environment surrounded by lush greenery.

Facilities/Notes

Room Notes

A fee is charge for use of the amateur-sports venue (summer season, Saturday, Sunday, and public holidays) 9:00am to 5:00pm. Rates change according to purpose and season.

The maximum capacity of the Main Stand and Back Stand is 17,324 persons. There is a fee for the use of the conference room alone.

Main Equipment for Loan or Rent

- Long desk, chairs, broadcast equipment

Other Facilities

- Circuit-training ● a maximum of eight tennis courts ● a maximum of four futsal coats

Service

Universal Accessibility





- Address...8-1, Makomanai Kashiwaoka 7-chome, Minami-ku, Sapporo
- Tel...+81-11-584-7555
- Fax...+81-11-584-7550
- URL...<http://www.hs-compass.com>
- Access
- [Subway] 8 mins. ride on Jotetsu Bus no. Minami 84 from Makomanai Station on the Nanboku Line.
- [Taxi] 30 mins. ride from Sapporo JR Station
- Parking
- 150 spaces, free of charge (a charge is applied for large-sized vehicles)

Convention Rooms

Name	Area (m ²)	Ceiling	Floor load	Dinner (people)	Buffet (people)	School (people)	Theater (people)	Basic rate (¥)
● Hall							652	(99,600)
● Large Conference Room [2F]	187					144		57,600
● Audio-visual Room [2F]	72							21,000
● Training Rooms 1,2,4,5 [2F]	51~57							16,000
● Training Room 3 (Japanese-style) [2F]	32					20		10,000
● Conference Room 1 [3F]	83					20		21,000
● Conference Room 2 [3F]	41					10		16,000
● Conference Room 3 [3F]	26					20		10,000
● Conference Room 4 (Japanese-style) [3F]	32					20		10,000

Basic rates are for normal all-day use, tax not included. Use in the morning, afternoon, or evening is also possible. For the figure in parentheses, please see more information at right. Please contact each facility directly for specific rates.

Hotel accommodation

Guestroom type	No. of rooms	No. of people	Notes
● Japanese-style	3		
● Single	9	9	With bath and toilet (total capacity 18 people if extra beds are used)
● Twin	14	28	With bath and toilet (total capacity 42 people if extra beds are used)
● Other	13	52	Rooms with bunk-beds for 4 people (without in-room bath or toilet) (total capacity 65 people if extra beds are used)
● Total	36	89	(total capacity 125 people if extra beds are used)

Restaurants and Bars

Type	Number	Capacity	Notes
● Restaurant	1	120	
● Shop	1		

Main Floor Plan

[2F]



Special Features

Located on a lush green hill in Makomanai, Sapporo. A combined facility for focused activities and experiences with overnight stay available, it was first built as the Sapporo Olympic Press Center. Available for use by anyone for many purposes, it contains accommodation, a hall, a gymnasium, a pool, etc.

Facilities/Notes

Room Notes

The hall rate shown at left is for the hours 9am~9pm. A heating surcharge is added in winter. Discount for use by elementary, junior high and high school students, youth groups, etc. (please enquire for more details).

Main Equipment for Loan or Rent

White board (1,000yen/day), wireless mike (1,000yen/day), projector (3,000yen/day). Please enquire regarding other equipment.

Service

Universal Accessibility





- Address...328, 4-chome, Jozankei-onsen-higashi, Minami-ku, Sapporo
- Tel...+81-11-598-2211
- Fax...+81-11-598-5211
- URL...<https://www.granj.co.jp>
- E-mail...zuien@granj.co.jp
- Access
- [Subway] 50 mins. by Jotetsu Bus from Makomanai Subway Station.
- [Taxi] 50 mins. ride from JR Sapporo Station.
- Parking
- 200 spaces, free of charge.

Convention Rooms

Name	Area (m ²)	Ceiling	Floor load	Dinner (people)	Buffet (people)	School (people)	Theater (people)	Basic rate (¥)
● Hakucho	165					100		(40,000)
● Tancho	165					150		(40,000)

Basic rates are for 8 hours' usage. See notes at right for further details about figures in parentheses. Tax not included. Please contact each facility directly for specific rates.

Hotel accommodation

Guestroom type	No. of rooms	No. of people	Notes
● Japanese-style	78	472	
● Single			
● Western-style room	88	192	
● Japanese-Western room	54	322	
● Total	220	986	

Restaurants and Bars

Type	Number	Capacity	Notes
● Restaurant	1	250	For breakfast and dinner buffet
● Bar	3	120	
● Tea Lounge	1	60	
● Shop	1		

Main Floor Plan

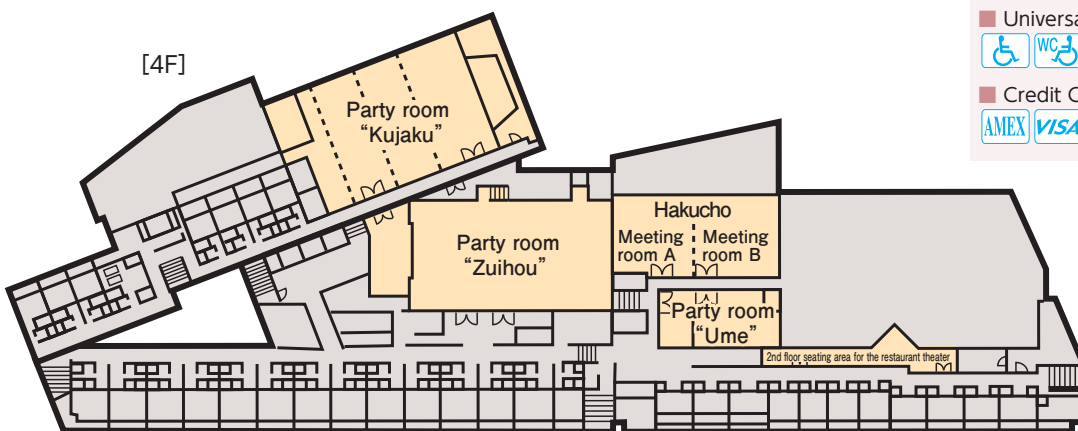

Special Features

This hotel is located in an area away from downtown Sapporo and offers seasonal flavors for every season. The large bathing room is marble, and there are various luxurious large baths, such as the all-granite large bath, a sauna, and an open-air bath.

Facilities/Notes

- Room Notes
- Basic rates are for 8 hours' usage. (There is no charge when a member of an organization uses the hall.)
- Other Facilities
- Light meal restaurant "Kobara Tei"
- Amusement area "Pon Pon Avenue" (Karaoke box, mahjong room, table tennis court)
- Karaoke Lounge Royal

Service

- Language Services
-
- Management Support
-
- Universal Accessibility
-
- Credit Cards Accepted
-
- etc.

Jozankei View Hotel



- Address...Higashi 2-chome, Jozankei Onsen, Minami-ku, Sapporo
- Tel...+81-11-598-3223
- Fax...+81-11-598-3222
- URL...<https://www.jozankeiview.com/>
- E-mail...jyouzankeiview@karakami-kankou.co.jp
- Access
[Subway] 40 mins. by bus from Makomanai Subway Station.
[Taxi] 50 mins. ride from Sapporo Station.
- Parking
400 spaces, free of charge.

Convention Rooms

Name	Area (m ²)	Ceiling	Floor load	Dinner (people)	Buffet (people)	School (people)	Theater (people)	Basic rate (¥)
View Hall	1,000			400		720	1,000	800,000
View Hall A	500					200		400,000
View Hall B	500			250		400		400,000

Basic rates are for 8 hours' usage. Please contact each facility directly for specific rates.

Hotel accommodation

Guestroom type	No. of rooms	No. of people	Notes
Japanese-style	437	2,104	
Suite	11		
Special room	18		
Twin	98	196	
Japanese-Western room	83		
Total	647	2,319	



Restaurants and Bars

Type	Number	Capacity	Notes
Restaurant	2	1,200	
Bar	2	280	
Tea Lounge	1	120	
Shop	1		

Main Floor Plan [1F]

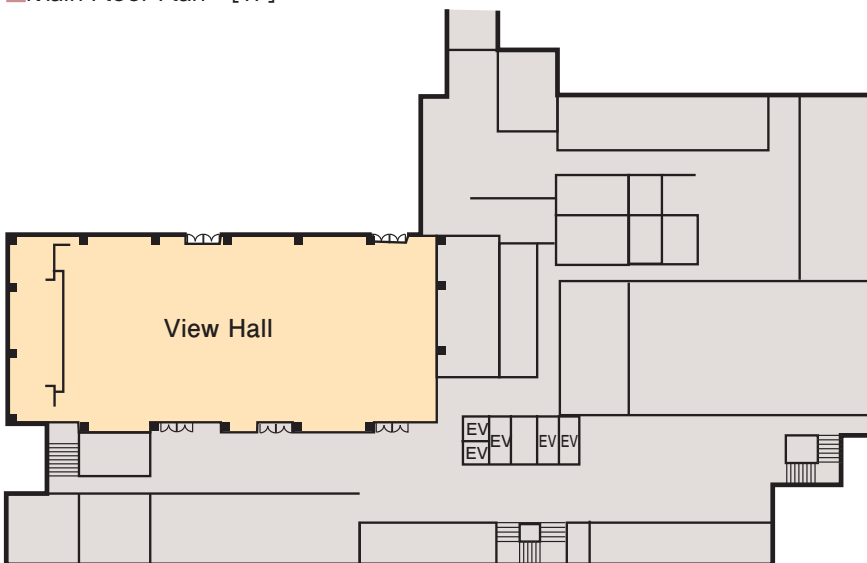

Special Features

This hotel boasts some of the largest facilities in the nation, such as "Lagoon", an indoor hot spring totaling 4,000 square meters, and "Seiten", a top-floor observatory bathing area 60 meters above the ground, as well as a large bathing area, "Yusuikyo", on the 1st and 2nd basement levels. Equipped with small conference rooms and multi-purpose halls, guests can take delight in delectable feasts at this hotel featuring a large bathing area, which befits its status as a hot spring resort.

Facilities/Notes

Room Notes
Conference room in the main building - View Hall: microphone, CD, MD, cassette tape.
Conference rooms in the new building - Vega Polaris, Sirius, Pegasus, Cosmos: microphone, cassette tape
Other equipment can also be rented for a fee.
There are seven conference rooms of various sizes.

Other Facilities

● Splash River ● wave pool ● running water pool ● kids' pool ● sauna ● open-air bath

Service

Universal Accessibility



Credit Cards Accepted



Jozankei Hotel



- Address...Nishi 4-chome, Jozankei Onsen, Minami-ku, Sapporo
- Tel...+81-11-598-2111
- Fax...+81-11-598-2110
- URL...<https://www.jozankei-hotel.com/>
- E-mail...info@jozankei.co.jp
- Access
- [Bus] About 1 hour by Jotetsu Bus from the front of Sapporo Station.
- [Taxi] 40 mins. ride from Sapporo JR Station
- Parking
150 spaces, free of charge

Convention Rooms

Name	Area (m ²)	Ceiling	Floor load	Dinner (people)	Buffet (people)	School (people)	Theater (people)	Basic rate (¥)
● Suzuran [3F]							20	(5,000)
● Shirakaba [7F]	376			150			200	(50,000)

Basic rates are for normal use between 8am and 10pm, tax not included. For the figures in parentheses, please see information at right. Please contact each facility for specific rates.

Hotel accommodation

Guestroom type	No. of rooms	No. of people	Notes
● Japanese-style	173	796	(Incl. Japanese-Western rooms)
● Suite	5	29	
● Single			
● Twin	9	18	
● Other	3	20	
● Total	190	863	

Restaurants and Bars

Type	Number	Capacity	Notes
● Restaurant	1	30	
● Bar	1	50	
● Shop	1		
● Convenience store	1		

Main Floor Plan

[7F]



Suzuran on the third floor
(fully equipped conference room)



Shirakaba on the seventh floor (Japanese room where the tatami floor can be converted into a wooden floor)

Special Features

This facility includes both accommodation and conference facilities.

Facilities/Notes

Room Notes

Rates shown are for full-day usage (8:00~22:00).

Main Equipment for Loan or Rent

Projector, Projector-Screen set :15,000yen (tax not included).

Other Facilities

● Sauna, large bathing area

Service

Language Services



Universal Accessibility



Credit Cards Accepted



Jozankei Manseikaku Hotel Milione



- Address...Higashi 3-chome, Jozankei Onsen, Minami-ku, Sapporo
- Tel...+81-11-598-3500
- Fax...+81-11-595-2131
- URL...<https://www.milione.jp/>
- Access
- [Bus] 65 mins. ride from JR Sapporo Station.
- [Taxi] 45 mins. ride from JR Sapporo Station.
- Parking
- 250 spaces, free of charge

Convention Rooms

Name	Area (m ²)	Ceiling	Floor load	Dinner (people)	Buffet (people)	School (people)	Theater (people)	Basic rate (¥)
● Convention Hall (Total area)	900			576	1,000	700	1,400	80,000~
● Convention Hall (Total area) ※Using rollback	900						824	80,000~
● Convention Hall (1)	318			200		270	289	80,000~
● Convention Hall (2)	362			200		290	340	80,000~
● Convention Hall (3)	205			100		140	170	80,000~
● Poplar	110			40	60	40	80	40,000~

Basic rates are for 8 hours' usage. Tax not included. Please contact each facility directly for specific rates.

Hotel accommodation

Guestroom type	No. of rooms	No. of people	Notes
● Japanese-style	218	1,130	16m ² +3m ²
● Suite	4	10	
● Single	10	10	14m ² room with semidouble bed
● Twin	79	160	28m ² room, can convert to triple
● Other			
● Total	312	1,310	

Restaurants and Bars

Type	Number	Capacity	Notes
● Restaurant	1	300	Buffet style.
● Bar	2	120	
● Tea Lounge	1	40	
● Shop	1		

Special Features

The hotel offers two types of guestrooms – Japanese- and Western-style. The Japanese-style rooms are 10 or 12 tatami-mat size, and have separate baths and toilets, while the 79 Western-style rooms are mainly twins. The large hall in this hot spring resort hotel can accommodate 1,000 guests, and is designed in buffet style. Audience seats can be arranged in a sloping style as well as school style.

Facilities/Notes

Room Notes

The Milione Hall can be divided into (1), (2) and (3).

Main Facilities

[Milione Hall] Wireless microphone, cable microphone, cassette deck, CD player, white board, OHP, video deck, recording equipment, stage

Main Equipment for Loan or Rent

Wireless microphone, cable microphone, cassette deck, CD player, overhead screen, video set, recording equipment, stage, white board, karaoke

Other Facilities

- Open-air swimming pool
- game center
- Japanese pub
- karaoke
- banquet hall
- conference room
- large bathing area

Service

Universal Accessibility



Credit Cards Accepted



AEON Card JACCS



Main Floor Plan

[B1]

